

ZC#24-010

This information is for illustrative purposes only. Not for design or development purposes. Site-specific studies may be required to obtain accurate feature locations. Every effort is made to ensure the information displayed here is accurate; however, the City of Mansfield makes no claims to its accuracy or completeness.

6/3/2024

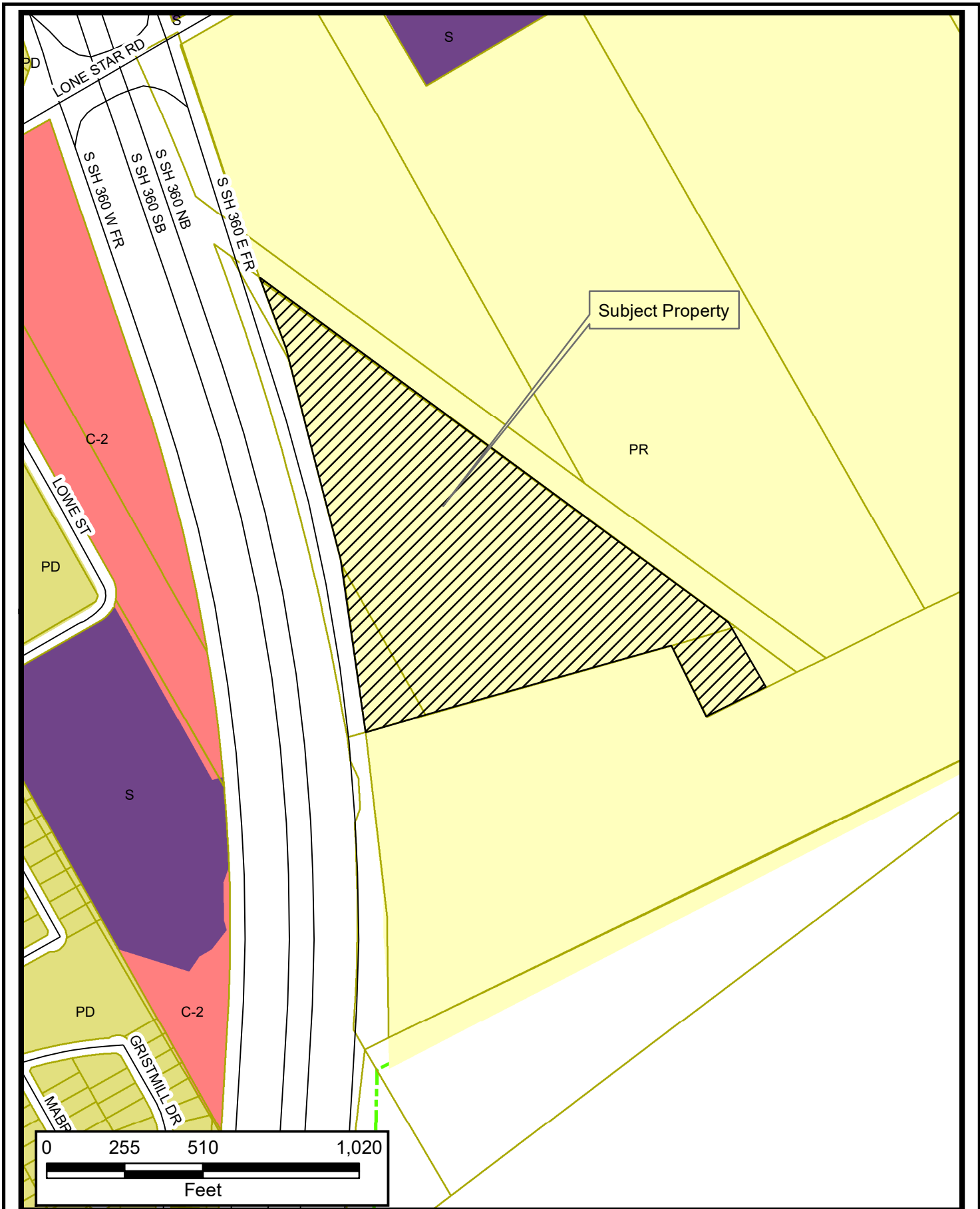

ZC#24-010

This information is for illustrative purposes only. Not for design or development purposes. Site-specific studies may be required to obtain accurate feature locations. Every effort is made to ensure the information displayed here is accurate; however, the City of Mansfield makes no claims to its accuracy or completeness.

6/3/2024

Property Owner Notification for ZC#24-010

LEGAL DESC 1	LEGAL DESC 2	OWNER NAME	OWNER ADDRESS	CITY	ZIP
385 M GREGG 1.622 ACRES		THREE SIXTY REALTY INC	3311 POLO DR	DELRAY BEACH, FL	33483--733
385 M GREGG 3.216 ACRES		THREE SIXTY REALTY INC	3311 POLO DR	DELRAY BEACH, FL	33483--733
616 385 J LAWRENCE M GREGG 0.223 ACRES		THREE SIXTY REALTY INC	3311 POLO DR	DELRAY BEACH, FL	33483--733
616 385 J LAWRENCE M GREGG 19.575 ACRES		THREE SIXTY REALTY INC	3311 POLO DR	DELRAY BEACH, FL	33483--733
616 385 J LAWRENCE M GREGG 1.755 ACRES		THREE SIXTY REALTY INC	3311 POLO DR	DELRAY BEACH, FL	33483--733
616 385 J LAWRENCE M GREGG 16.263 ACRES		THREE SIXTY REALTY INC	3311 POLO DR	DELRAY BEACH, FL	33483--733
616 385 J LAWRENCE M GREGG 36.26 ACRES		PHILLIPS FAMILY LIVING TRUST	3320 CHADWELL	DALLAS, TX	75234
616 J LAWRENCE 0.667 ACRES		PHILLIPS JUDITH A	3320 CHADWELL DR	FARMERS BRANCH, TX	75234--512
616 J LAWRENCE 1.886 ACRES		SUNBELT LAND INVESTMENT 360 LT	3015 NEW YORK AVENUE SUITE 201	GRAND PRAIRIE, TX	75052
616 J LAWRENCE 101.284 ACRES		SUNBELT LAND INVESTMENT 360 LT	3015 NEW YORK AVENUE SUITE 201	GRAND PRAIRIE, TX	75052
616 J LAWRENCE, 5.0680 ACRES		TARRANT CO WATER	800 E NORTHSIDE DR	FORT WORTH, TX	76102--101