

City of Mansfield

Height variance request

Lot located at 841 Seeton Rd.

April 3, 2023

Lot size 101,113.2 sq ft or 2.32 acres

Owned by Dave and Sandra Homet

To whom it may concern-

I am requesting a height variance for a structure I wish to construct on my property for the purpose of providing general storage and an RV covering. The covered structure is 44 feet wide (includes 14' wide porch) by 40 feet long with an internal clearance of 14 feet, and a total peak height of 18 feet. Square footage is therefore 1760 sq. ft under roof. This will be a steel structure that will be anchored on all sides into a poured slab.

The structure is to be placed at the rear of the property as follows:

- 114 ft back from the rear of the house (west side)
- 140 ft from the east (rear) property line
- 24 ft back from the north (side) property line
- 107 ft from the south (side) property line

Please refer to the attached site plan and elevations for further details.

Thank-you for your consideration of my request.

Sincerely,

Dave Homet

817-437-3110

Dave.homet@gmail.com

JOHN
Coordinat

GLADATA SURVEYING, INC.

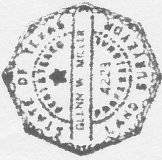

As my authority expires on 09/01/2024, I hereby certify that I am a duly licensed Professional Surveyor in the State of Texas, License No. 4223, Commission Expires 09/01/2024.

GLENN W. MUELLER
4223
09/01/2024

BEARING SHOWS ARE BASED ON P.L.A.
AND PROPERTY IS LOCATED IN ZONE
14N 07E 01S, SECTION 36, T.14N.07E,
R.01S, COUNTY OF TARRANT, TEXAS.
AROUND CORNER DATED AUG. 2, 1988
THE CORNER TO THIS ELECTRIC
LINE MAY BE IN THE "DANGER"
ZONE OF THE POWER LINE.
THE LOCATION TO THIS POWER LINE
MAY BE IN THE "DANGER" ZONE.
USE TO VIEW THE DESCRIPTION.

N 00°41'29" E - 20.2'

S 75°48'45" E - 478.21'

308.56'
18.55'

N 12°39'56" W - 225.15'

S 89°50'00" W - 199.65'

140' to rear line

114' to house

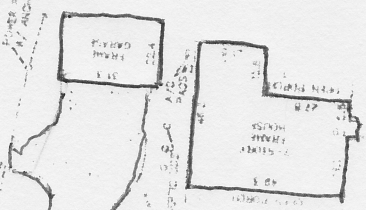
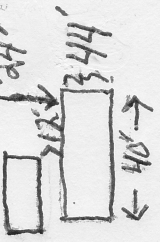

324.78'

S 51°37'00" W - 324.78'

071 SELTON ROAD

