

Revision / Date

**A DEVELOPMENT PLAN FOR
CENTER FOR THE PERFORMING ARTS
FOR
MANSFIELD I.S.D.
MANSFIELD, TEXAS**

Adams ENGINEERING
ARCHITECTURE
INTERIOR DESIGN
LANDSCAPE ARCHITECTURE
PLANNING
CONSTRUCTION MANAGEMENT

11011 Regattini # 1102
Huckabee
ARCHITECTURE
INTERIOR DESIGN
LANDSCAPE ARCHITECTURE
PLANNING
CONSTRUCTION MANAGEMENT

4501 South Main, Suite 210
Fort Worth, TX 76116
PH: 817.377.2888
F: 817.377.2883
www.huckabee-inc.com

OVERALL SITE PLAN
Sheet No. **SP-1**
Drawn By: [Name]
Date: [Date]
Scale: [Scale]

ZC#10-012
of [Number]

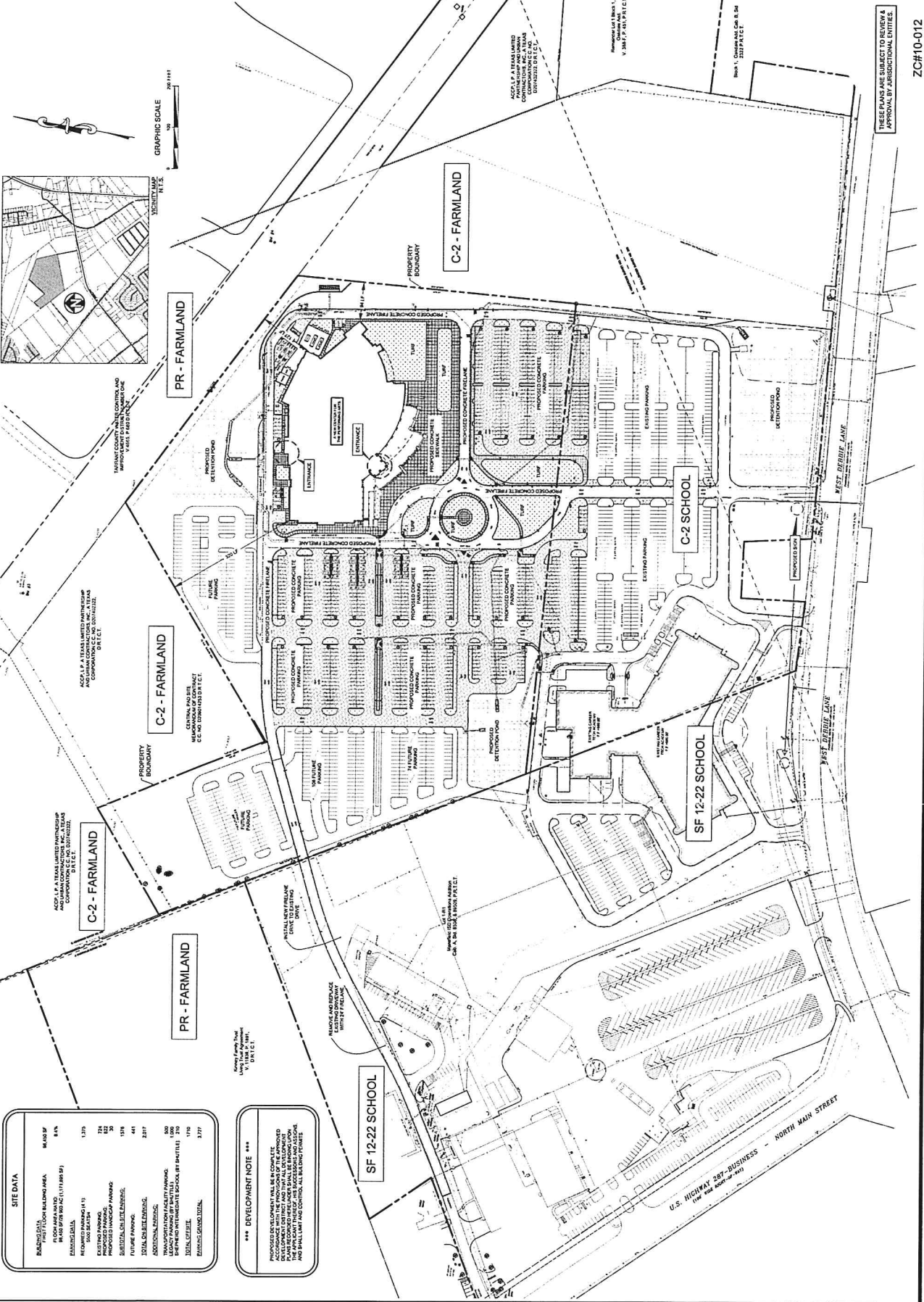

SITE DATA

ITEM	AMOUNT
EXISTING TOTAL FLOOR AREA	814
PROPOSED TOTAL FLOOR AREA	1,379
EXISTING TOTAL FLOOR AREA (EXCLUDING EXISTING PARKING)	724
PROPOSED TOTAL FLOOR AREA (EXCLUDING PROPOSED PARKING)	55
EXISTING TOTAL FLOOR AREA (EXCLUDING EXISTING PARKING AND EXISTING DRIVEWAYS)	194
PROPOSED TOTAL FLOOR AREA (EXCLUDING PROPOSED PARKING AND EXISTING DRIVEWAYS)	441
EXISTING TOTAL FLOOR AREA (EXCLUDING EXISTING DRIVEWAYS)	2,817
PROPOSED TOTAL FLOOR AREA (EXCLUDING PROPOSED DRIVEWAYS)	800
EXISTING TOTAL FLOOR AREA (EXCLUDING EXISTING DRIVEWAYS AND EXISTING DRIVEWAYS)	1,170
PROPOSED TOTAL FLOOR AREA (EXCLUDING PROPOSED DRIVEWAYS AND EXISTING DRIVEWAYS)	3,277

***** DEVELOPMENT NOTE *****
PROPOSED DEVELOPMENT SHALL BE IN COMPLETE ACCORDANCE WITH ALL APPLICABLE REGULATIONS AND ORDINANCES AND SHALL BE SUBJECT TO THE APPROVAL OF THE CITY OF MANSFIELD AND THE TEXAS DEPARTMENT OF TRANSPORTATION. THE CITY OF MANSFIELD AND THE TEXAS DEPARTMENT OF TRANSPORTATION SHALL HAVE THE FINAL SAY IN ALL MATTERS RELATING TO THE DEVELOPMENT AND SHALL BE RESPONSIBLE FOR OBTAINING ALL NECESSARY PERMITS AND APPROVALS.

PREVIOUSLY APPROVED DEVELOPMENT PLAN

Huckabee

New MISD Auditorium and Professional Development Center

