

ANDY BINZ	PARKS	
DAVID BOSKI	STREETS	
ERIC PETERSON	FIRE	
LISA SUDBURY	PLANNING	
KYLE LANIER	POLICE	
PAUL COKER	DEV SERVICES	

APPROVALS

RECEIVED  
SEP 04 2014

BY: 

 **MANSFIELD**  
TEXAS  
1200 East Broad Street, Mansfield, TX 76063  
www.mansfield-tx.gov Fax: 817-477-1416

### Special Event Application

Organization/Group: <u>Run with Heart 1/2 Marathon 5K</u>	Date: <u>8/01/14</u>
Applicant: <u>Methodist Mansfield Medical Center / RunFAR Racing Services Inc.</u>	
Applicant's Address: <u>2700 E Broad St</u>	Phone No. <u>817-512-565-2532</u>
* Will be called for information needed and when the permit is ready for pick-up	Email: <u>meghan@run-far.com</u>
Address of Event: <u>2700 E. Broad St</u>	
Description & Activities: <u>Half Marathon 5K Through the City</u>	
Date of Event: <u>Saturday October 11, 2014</u>	Hours of Event: <u>7am-11:00am</u>
Public Invited or Private Party? <u>Public Invited</u>	Estimated Number of Attendees: <u>1500</u>
Is the event in a Mansfield Park? <u>Yes, Walnut Creek Linear Park</u>	*If yes, Insurance is required
Do you plan to Temporarily Close a Public Street? <u>Yes</u>	*If yes, Insurance is required
Is the event on Private Property other than your own? <u>No</u>	*If yes, signed permission is required
Will there be any new or temporary electric lines installed?	
*If yes, a registered Electrician must obtain a permit. Indicate the line locations on the site plan.	
Will you be using generators? <u>No</u>	*If yes, show location on the site plan
Do you plan to have any Tents? <u>No</u>	*If yes, a separate permit is required.
Do you plan to have any Promotional Signs? (banners, streamers, balloons) <u>Yes</u>	*If yes, a separate permit is required
City of Mansfield Assistance Requested:	
Barricades/ Street Closure?	*If yes, show on site plan where you want to close the street and a resident roster must be submitted
Police/Traffic Control/Security? <u>Ken Hopkins w/ PD</u>	*If yes, attach an explanation and the name and contact number of person you are making arrangements with.
<p><b>Please Read and Include the Following Information With This Application</b></p> <ul style="list-style-type: none"> <li>For all outdoor activities, a site plan must be attached. One can be provided if requested. You need to show where all items will be located on the site plan.</li> <li>If Insurance is required, the City of Mansfield must be listed as "Additional Insured".</li> <li>All documents must be turned in at the same time. Please allow enough time for review and approval before the date of your event.</li> </ul>	
Applicant's Printed Name:	Applicant's Signature:
<u>Meghan Hajera</u>	<u>Meghan Hajera</u>

Meghan Hajera  
Paul Wajera

9-27-12

\* insurance policy to be provided before the event  
\* parking permission with misd will be provided before event.



# Run with Heart 2014 WORKING SITE Map

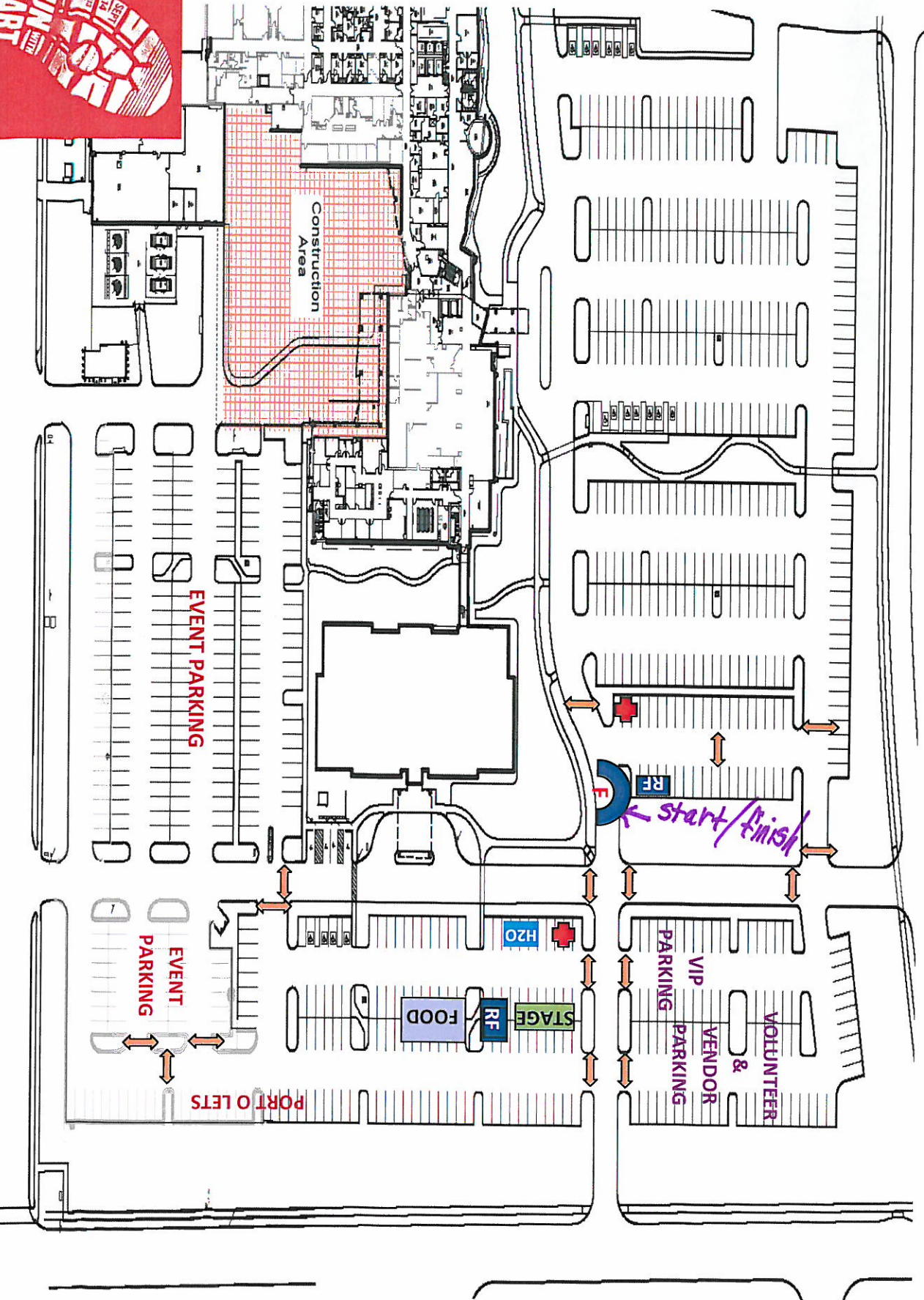



Run with Heart 5K • 5 kilometers • USATF Certification TX13136ETM  
Effective 07.16.2013 to 12.31.2023  
Measured by Logan Burgess 06.21.2013 • Mansfield, TX  
Map not to scale • No restrictions



**Start** - (N32 34 09.2 W97 05 36.8) - Methodist Mansfield Medical Campus - N of Professional Building 1 - 2'6" W of light pole #41  
**Mile 1** - (N32 34 00.9 W97 05 26.9) - Miller Rd just S of Dove Valley Ln - even with utility pole 3894750 8519986 at N exit of church  
**Mile 2** - (N32 33 55.2 W97 05 43.2) - NB Matlock just S of Hospital Dr - even with 3rd light pole S of Hospital Dr  
**Mile 3** - (N32 34 08.4 W97 05 32.4) - Miller Rd just N of Hospital Dr - 20' N of utility pole 3894256 3520701  
**Finish** - (N32 34 09.2 W97 05 36.8) - Common with Start - N of Professional Building 1 - 2'6" W of light pole #41

This course has been measured to USATF guidelines following the shortest possible route - no restrictions.

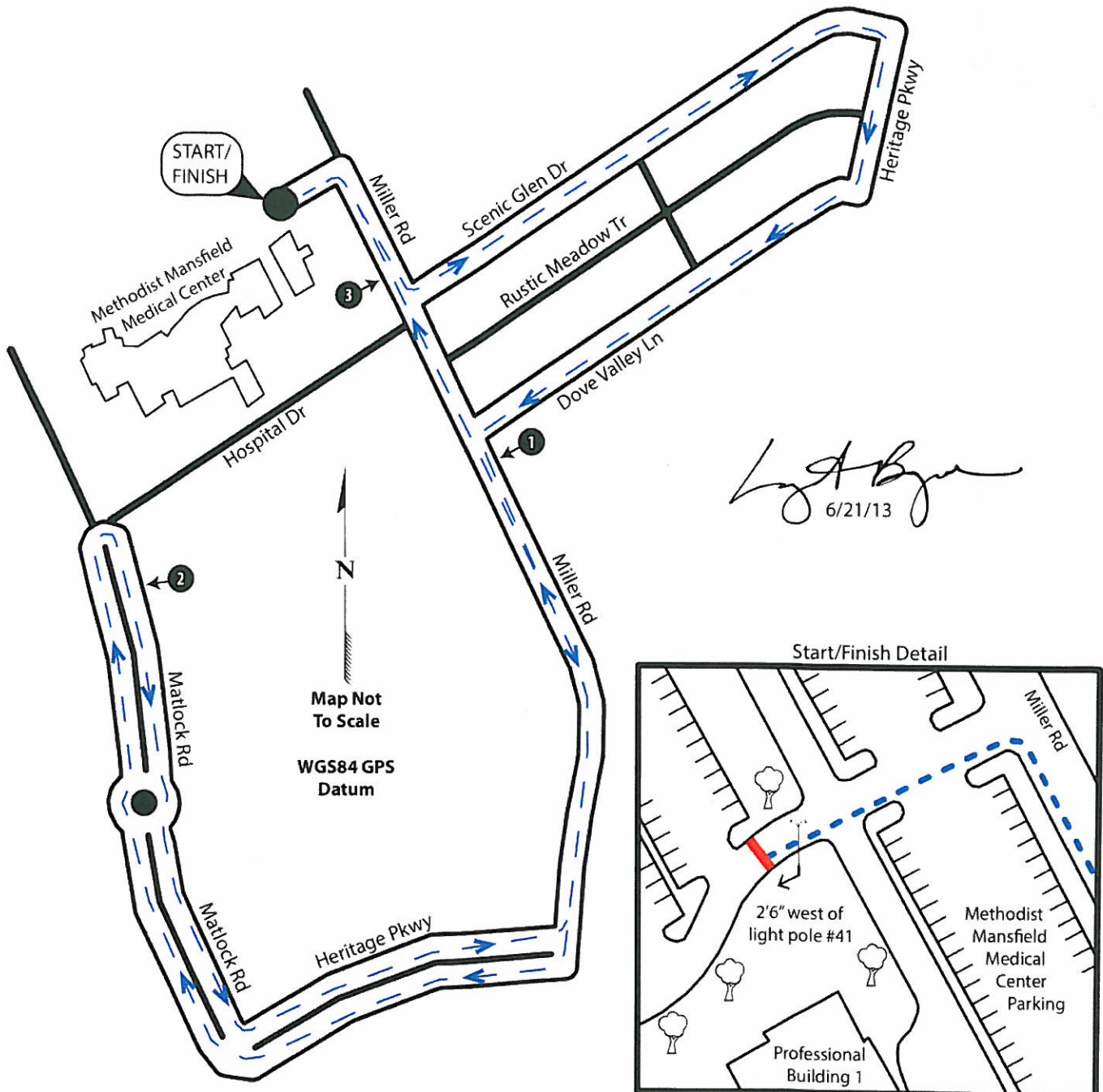





Road Running Technical Council  
USA Track & Field  
**Measurement Certificate**



Name of the course Run with Heart 5K Distance 5 km  
Location (state) TX (city) Mansfield  
Type of course: road race ☒ calibration ☐ track ☐ Configuration: Key Hole  
Type of surface: paved 100 % dirt      % gravel      % grass      % track      %  
Elevation (meters above sea level) Start 189 m Finish 189 m Highest 193 m Lowest 180 m  
Straight line distance between start & finish 0 Drop 0 m/km Separation 0 %  
Measured by (name, address, phone & e-mail) Logan Burgess; 1958 Eastpark Dr; Richardson, TX  
75081 214.803.7800 loganaburgess@yahoo.com  
Race contact (name, address, phone & e-mail) Angel Biasatti; 2700 E Broad St; Mansfield, TX  
76063 682.622.2063 angelbaisatti@mhd.com  
Measuring Methods: bicycle ☒ steel tape ☐ electronic distance meter ☐  
Number of measurements of entire course: 2 Date(s) when course measured: Jun 21, 2013  
Race date: Sep 14, 2013 Course certification effective date: Jul 16, 2013  
Certification code: TX13136ETM

Notice to Race Director: Use this Certification Code  
in *all* public announcements relating to your race.

**Be It Officially Noted That**

Based on examination of data provided by the above named measurer, the course described above and in the map attached is hereby certified as reasonably accurate in measurement according to the standards adopted by the Road Running Technical Council. If *any* changes are made to the course, this certification becomes void, and the course must then be recertified.

**Verification of Course** — In the event a National Open Record is set on this course, or at the discretion of USA Track & Field, a verification remeasurement may be required to be performed by a member of the Road Running Technical Council. If such a remeasurement shows the course to be short, then all pending records will be rejected and the course certification will be cancelled.

*This certification expires on December 31 in the year* **2023**

**AS NATIONALLY CERTIFIED BY:**

*ET McBrayer*

E. T. (Tom) McBrayer— USATF/RRPC National Certifier

Date: Jul 16, 2013

4021 Montrose Blvd; Houston, TX 77006; 713-523-5679; etmmam@gmail.com



Run with Heart Half Marathon • 21.0975 kilometers • USATF Certification TX13135ETM  
 Effective 07.16.2013 to 12.31.2023  
 Measured by Logan Burgess 06.21.2013 • Mansfield, TX  
 Map not to scale • Restrictions as noted on map

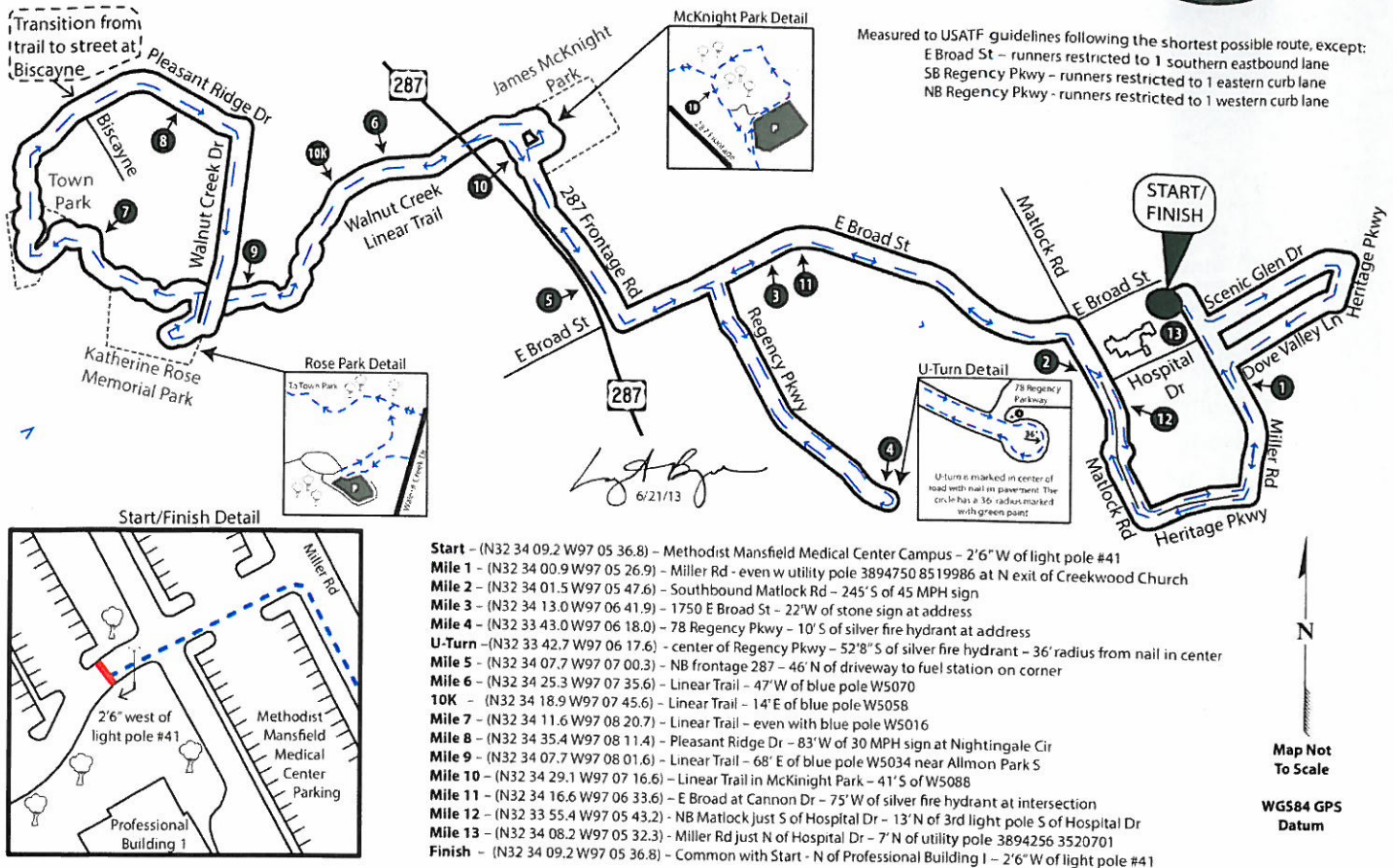



Road Running Technical Council  
USA Track & Field

# Measurement Certificate



Name of the course Run with Heart Half Marathon Distance 21.0975 km  
Location (state) TX (city) Mansfield  
Type of course: road race ☒ calibration ☐ track ☐ Configuration: Key Hole  
Type of surface: paved 100 % dirt      % gravel      % grass      % track      %  
Elevation (meters above sea level) Start 189 m Finish 189 m Highest 199 m Lowest 180 m  
Straight line distance between start & finish 0 Drop 0 m/km Separation 0 %  
Measured by (name, address, phone & e-mail) Logan Burgess; 1958 Eastpark Dr; Richardson, TX  
75081 214.803.7800 loganaburgess@yahoo.com  
Race contact (name, address, phone & e-mail) Angel Biasatti; 2700 E Broad St; Mansfield, TX  
76063 682.622.2063 angelbaisatti@mhd.com  
Measuring Methods: bicycle ☒ steel tape ☐ electronic distance meter ☐  
Number of measurements of entire course: 2 Date(s) when course measured: Jun 21, 2013  
Race date: Sep 14, 2013 Course certification effective date: Jul 16, 2013

Certification code: TX13135ETM

Notice to Race Director: Use this Certification Code  
in *all* public announcements relating to your race.

## Be It Officially Noted That

Based on examination of data provided by the above named measurer, the course described above and in the map attached is hereby certified as reasonably accurate in measurement according to the standards adopted by the Road Running Technical Council. If *any* changes are made to the course, this certification becomes void, and the course must then be recertified.

**Verification of Course** — In the event a National Open Record is set on this course, or at the discretion of USA Track & Field, a verification remeasurement may be required to be performed by a member of the Road Running Technical Council. If such a remeasurement shows the course to be short, then all pending records will be rejected and the course certification will be cancelled.

*This certification expires on December 31 in the year* 2013

AS NATIONALLY CERTIFIED BY:

Date: Jul 16, 2013

E. T. (Tom) McBrayer— USATF/RRCA National Certifier

4021 Montrose Blvd: Houston, TX 77006; 713-523-5679; etmmam@gmail.com





Mansfield Police Department  
1305 E. Broad Street, Mansfield, Texas 76063

Gary L. Fowler, Chief of Police

August 21, 2014

Clark Fulbright  
Traffic Operations -TXDOT Fort Worth District  
2501 SW Loop 820  
Fort Worth, Texas 76133

Re: Outside lane closure N US 287 East Frontage Road (100blk. to the 700 blk.)

Dear Mr. Fulbright,

Mansfield Methodist Hospital has scheduled a "Run with Heart" half marathon scheduled for Saturday, October 11, 2014 from 6:00am to 11:00pm.

The Mansfield Police Department will be working with various agencies to make this endeavor a safe and successful event. We have reviewed the event plans and have approved the location of street closures and detours. A map showing the routes has been enclosed. This route will provide the best route for a safe and successful event.

In accordance with our traffic plans, Run Far Racing Services will be responsible for all the necessary barricades, detour signs, cones, and other traffic-control devices. The police will be assigned to traffic enforcement to ensure public safety as well as access for abutting property owners and emergency vehicles.

If you have any questions, please contact me at 817 276-4723 or Sgt. Ken Hopkins at 817 804-5704.

Sincerely,

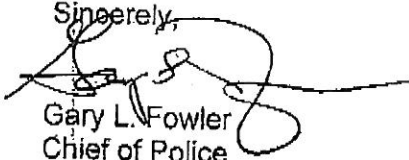
  
Gary L. Fowler  
Chief of Police

encl: Map



1200 East Broad Street, Mansfield, TX 76063  
www.mansfield-tx.gov Fax: 817-477-1416

### Promotional Signage Display Application

Installation Address	2700 E. Broad St	Suite No.	
Tenant/Business	Mansfield Run with Heart Event		
Applicant*	Run Far Racing	Phone No.	
*Will be called for information about the sign and when the permit is ready for pick-up			

Sign Company N/A					
Name			Contact Name		
Address			City	State	Zip
Phone No.			Email		

* Various Vendors for event			
Purpose of Sign			
Special Event <input checked="" type="checkbox"/>	Sale or Promotion <input type="checkbox"/>	Grand Opening <input type="checkbox"/>	Other <input type="checkbox"/>

Date Requesting Display to Begin	* 5m. arrows to show direction
----------------------------------	--------------------------------

Type of Sign			
Banner <input checked="" type="checkbox"/>	Quantity: 1-5	Size in Sq Feet	Height and Width in Feet
Balloon <input checked="" type="checkbox"/>	Quantity: archway	Wind Signs (pennants, streamers) <input checked="" type="checkbox"/>	Quantity: 1-10

<b>Please read and Include the Following Information With This Application</b> THIS PERMIT APPLICATION WILL BE AUTOMATICALLY <u>DENIED</u> IF ALL INFORMATION IS NOT COMPLETED/PROVIDED.	
1. <b>SIGN CONTENT:</b> For all signs, include a simple drawing or attach a picture of the sign, showing sign content and dimensions. <b>List everything that you plan to put up for the promotion.</b>	
2. <b>SITE PLAN SHOWING LOCATION OF SIGN(S):</b>	
A. For wall signs or banners, include a drawing of the face of the building with the sign(s). Label dimensions of buildings and sign(s).	
B. For all other signs, show the sign and its relation to the building on the property and to the lot boundaries. Label distances of sign(s) from building and lot boundaries.	
3. <b>NOTE:</b> One promotional signage display, (temporary signs such as banners, balloons, streamers or any kind of wind sign) is permitted three (3) times in a calendar year, for a maximum of fourteen (14) consecutive days. A minimum of ninety (90) days is required between each display. One (1) Grand Opening display is allowed for a period of twenty-one (21) consecutive days within the first three (3) months of the date of issuance of a certificate of occupancy or business license.	Permit Fee <del>\$40</del> N/A

Applicant's Signature	Linda Johnson for applicant *
Property Owner or Manager Printed Name & Signature	*REQUIRED

FOR OFFICE USE			
Comments			
Planning Dept	Approve <input type="checkbox"/>	Deny <input type="checkbox"/>	Date