

SITE DATA TABLE	
LOT #	LOT 1 BR1
SITE AREA	3.575 AC 155,723 SF
USE	MEDICAL OFFICE BUILDING
BUILDING AREA	33,148 SF
COVERAGE	21%
PARKING SPCS REQ	111
PARKING SPCS PROV	168
H.C. REQUIRED	6
H.C. PROVIDED	8 (4 VAN)

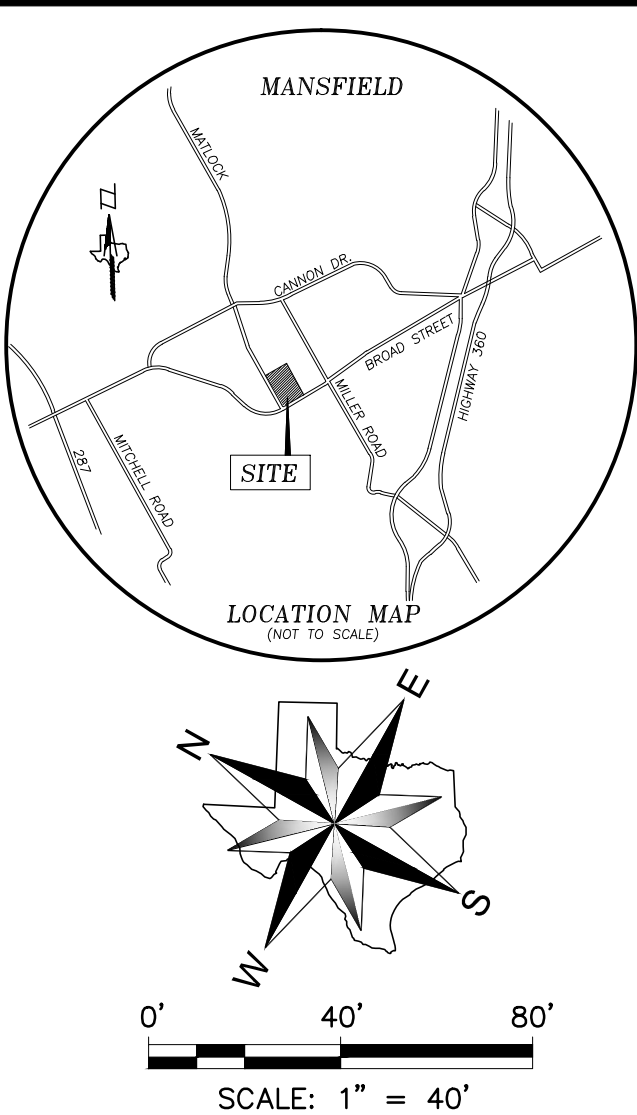

SITE PLAN  
BROAD STREET MEDICAL  
LOT 1 BR BLOCK 1 (3.57 AC)  
RICHARD BRATTON SURVEY, ABSTRACT NO. 114  
COUNTY OF TARRANT  
MANSFIELD, TEXAS  
SEPTEMBER 22, 2014

DEVELOPER:  
MTAL REALTY, L.L.C.  
505 PECAN ST., STE. 101  
FORT WORTH, TEXAS 76102  
PHONE (817) 632-4576  
FAX (817) 529-3205

ENGINEER:  
WINKELMANN & ASSOCIATES, INC.  
6750 HILLCREST PLAZA DR. SUITE #325  
DALLAS, TEXAS 75230  
PHONE (972) 490-7090  
FAX (972) 490-7099

#14-1054

PRELIMINARY – NOT FOR CONSTRUCTION

SITE PLAN

BROAD STREET MEDICAL

MANSFIELD, TEXAS

C-1.0

Winkelmann & Associates, Inc.

CONSULTING CIVIL ENGINEERS • SURVEYORS

6750 HILLCREST PLAZA DR. SUITE 325

DALLAS, TEXAS 75230

PHONE (972) 490-7090

FAX (972) 490-7099

CORPORATE OFFICE: 6750 HILLCREST PLAZA DR. SUITE 325, DALLAS, TEXAS 75230

1. 10-09-14

DATE

REVISION

COUNCIL REQUEST REVISIONS

MDC

APPROVED

LAST SAVED BY: CCHESHER September 22, 2014

54805.DWG

Previously Approved PD