



Casteel Sign

11116 Morrison Lane
Dallas, TX 75229
T 214.352.7466 F 214.352.7468
www.casteelsign.com

Mansfield ISD Center for the
Performing Arts
1110 W Debbie Lane
Mansfield, TX 76063

Project No.:

Theater Sign with
Electronic Message Center

Specifications

Sign Type: M
Date: 09.19.2017

Scale: See Drawing
A... (small text regarding copyright and permission of Mansfield ISD)

EXT.01

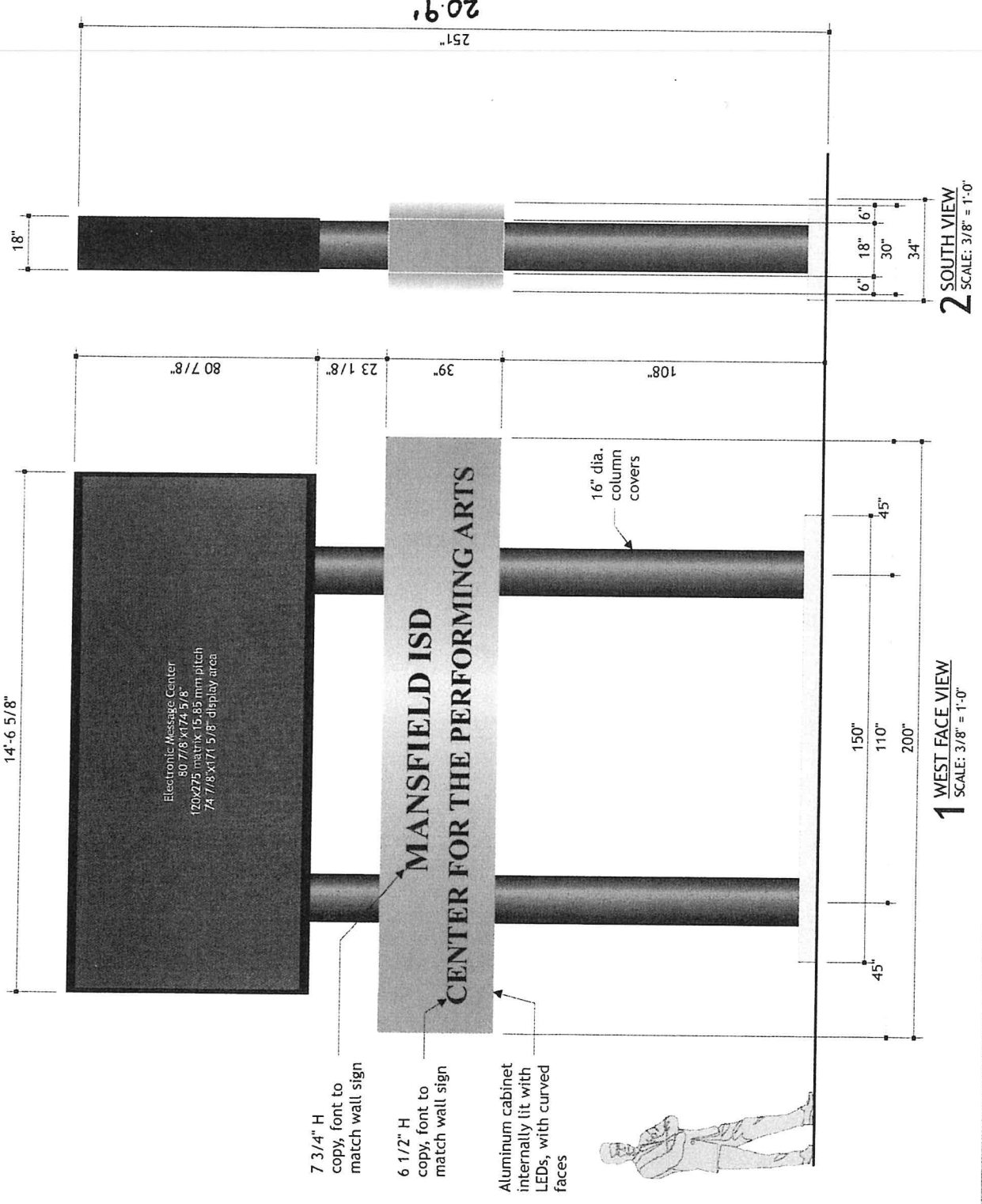



Casteel Sign

11106 Morrison Lane
Dallas, TX 75249
T 214.352.7466 F 214.352.7468
www.casteelsign.com

Wardfield ISD Center for the
Performing Arts
1110 W Debbie Lane
Amarfield, TX 76663

Project No.:

Theater Sign with
Electronic Message Center

Specifications

Sign Type: M

Date: 09.19.2017

Scale:

See Drawing

ALL DIMENSIONS ARE TO FACE UNLESS OTHERWISE SPECIFIED.
DIMENSIONS IN PARENTHESES ARE FOR INFORMATION ONLY.
DIMENSIONS IN SQUARE BRACKETS ARE FOR INFORMATION ONLY.
DIMENSIONS IN ITALIC FONT ARE FOR INFORMATION ONLY.
DIMENSIONS IN BOLD FONT ARE FOR INFORMATION ONLY.
DIMENSIONS IN SMALL FONT ARE FOR INFORMATION ONLY.
DIMENSIONS IN LARGE FONT ARE FOR INFORMATION ONLY.
DIMENSIONS IN X-LARGE FONT ARE FOR INFORMATION ONLY.
DIMENSIONS IN XX-LARGE FONT ARE FOR INFORMATION ONLY.

EXT.02

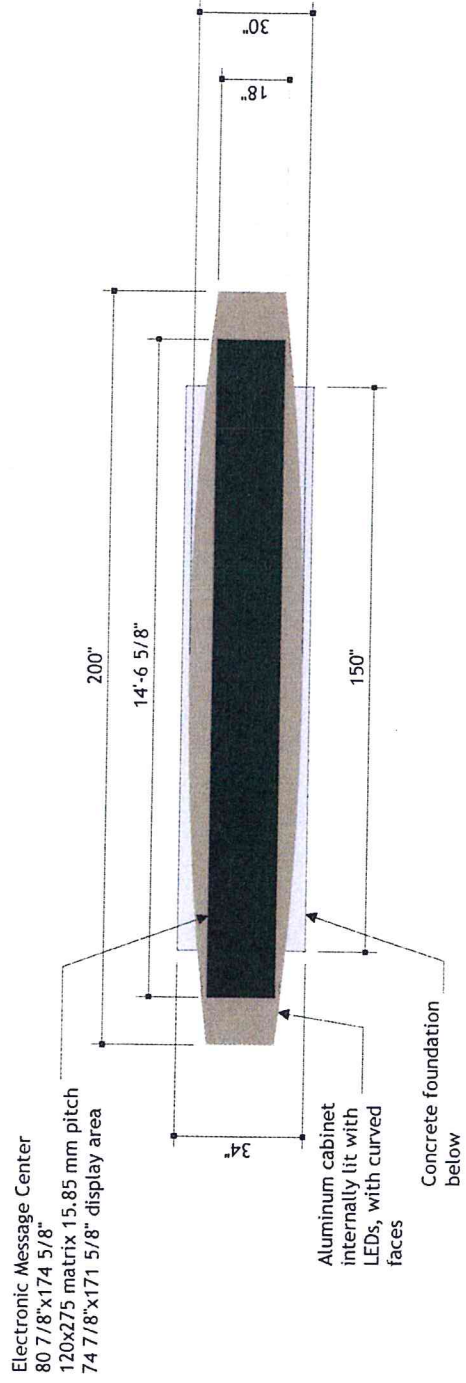

1 PLAN VIEW
SCALE: 3/8" = 1'-0"

Revision / Date

**A DEVELOPMENT PLAN FOR
CENTER FOR THE PERFORMING ARTS
FOR
MANSFIELD, TEXAS**



10000 Parkway
Dallas, Texas 75244
Tel: 972.333.1111
www.adamseng.com

Huckabee
10000 Parkway
Dallas, Texas 75244
Tel: 972.333.1111
www.huckabee.com

Job No. _____
Sheet No. **SP-1**
Drawn By: _____
Date: JAN 24, 2009

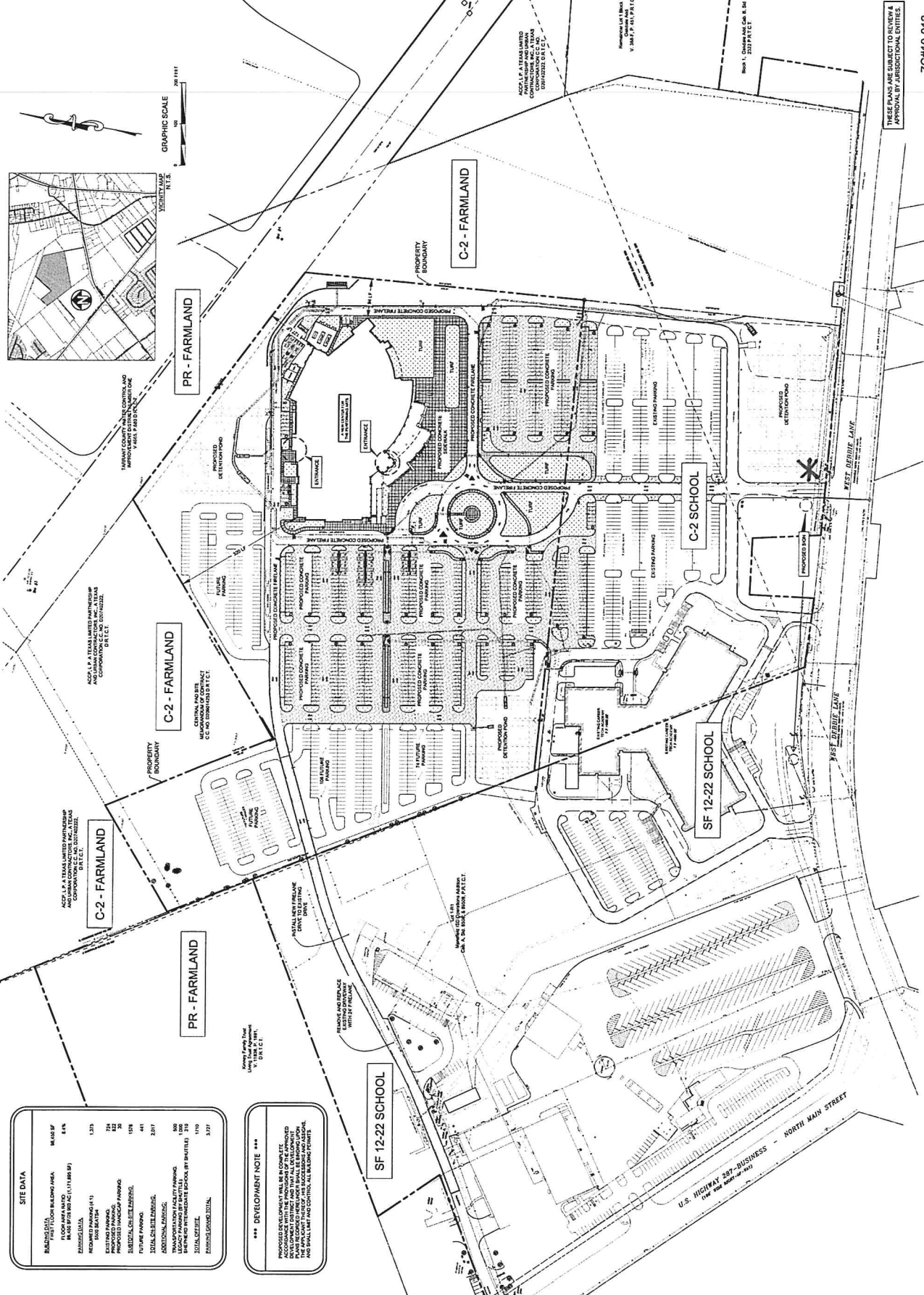

SITE DATA

BUILDING DATA	MASS SF	1,379
FIRST FLOOR BUILDING AREA	8.4%	724
FLOOR AREA RATIO		724
PERMITTED MAXIMUM (1.0) (MAX 9')		30
PERMITTED MAXIMUM (1.5)		159
PERMITTED MAXIMUM (2.0)		441
PERMITTED MAXIMUM (3.0)		2,917
PERMITTED MAXIMUM (4.0)		3,889
PERMITTED MAXIMUM (5.0)		4,861
PERMITTED MAXIMUM (6.0)		5,833
PERMITTED MAXIMUM (7.0)		6,805
PERMITTED MAXIMUM (8.0)		7,777

***** DEVELOPMENT NOTE *****
PROPOSED DEVELOPMENT SHALL BE CONFORMANT WITH ALL APPLICABLE ZONING REGULATIONS AND ALL CITY ORDINANCES. THE DEVELOPER SHALL BE RESPONSIBLE FOR OBTAINING ALL NECESSARY PERMITS AND APPROVALS FROM THE CITY OF MANSFIELD, TEXAS. THE DEVELOPER SHALL BE RESPONSIBLE FOR OBTAINING ALL NECESSARY PERMITS AND APPROVALS FROM THE CITY OF MANSFIELD, TEXAS.



THESE PLANS ARE SUBJECT TO REVIEW & APPROVAL BY JURISDICTIONAL ENTITIES.

ZC#10-012