

VICINITY MAP
(NOT TO SCALE)

NOTES:

1. NO PORTION OF THE SUBJECT PROPERTY LIES WITHIN A FEMA DESIGNATED FLOODPLAIN OR FLOOD PRONE AREA, ACCORDING TO JOHNSON COUNTY FLOOD INSURANCE RATE MAP No. 48251C0125J, WITH AN EFFECTIVE DATE OF DECEMBER 4, 2012.
2. NOTICE: SELLING A PORTION OF ANY LOT IN THIS ADDITION BY METES AND BOUNDS IS A VIOLATION OF STATE LAW AND CITY ORDINANCE AND IS SUBJECT TO PENALTIES IMPOSED BY LAW.
3. ALL PROPERTY CORNERS SHALL BE MONUMENTED WITH 1/2 INCH IRON ROD SET WITH A CAP STAMPED "GAI" UNLESS OTHERWISE SHOWN HEREON.
4. THE BEARINGS SHOWN HEREON ARE CREATED FROM ACTUAL FIELD SURVEYS, RELATED TO THE TEXAS STATE PLANE COORDINATE SYSTEM, NORTH CENTRAL ZONE (1983-2011) GRID BEARINGS.
5. A MANDATORY HOME OWNERS ASSOCIATION WILL BE RESPONSIBLE FOR THE MAINTENANCE OF THE PRIVATE AMENITIES, INCLUDING THE "X" LOTS NOT DESIGNATED AS PUBLIC PARK LAND, SCREENING WALLS AND FENCES, ENTRY FEATURES, ANY LANDSCAPING IN PUBLIC RIGHT-OF-WAY (INCLUDING STREET TREES), MEDIANS, AND LANDSCAPE BUFFERS.
6. "X" LOTS WITHIN EACH BLOCK SHALL BE DESIGNATED AS A UTILITY EASEMENT, DRAINAGE EASEMENT, AND ARE NON-BUILDABLE LOTS.
7. NO TREES, BUSHES, WALLS, SIGNS OR ANYTHING OVER 2' IS ALLOWED WITHIN THE VISIBILITY EASEMENTS.
8. FLOODPLAIN PER HYDROLOGIC & HYDRAULIC ANALYSIS FOR A PORTION OF AN UN-NAMED TRIBUTARY TO JOE POOL LAKE PREPARED BY GRAHAM ASSOCIATES, INC.
9. THE ACCESS EASEMENT ON LOT 15X, BLOCK 3 IS FOR THE USE OF THE GAS WELL OPERATOR OF THE WALKING T/EAGLE FORD DRILL SITES. NO IMPROVEMENTS SHALL BE MADE THAT IMPEDE INGRESS AND EGRESS ALONG THIS EASEMENT.
10. THE ACCESS EASEMENT ON LOT 15X, BLOCK 3 SHALL BE MAINTAINED BY THE GAS WELL OPERATOR.

LEGEND

FIR = FOUND 1/2 INCH IRON ROD WITH A CAP STAMPED "GRAHAM ASSOC INC"

BLOCK 13 = BLOCK NUMBERS

15 = LOT NUMBERS

1X = "X" LOT

↓ = STREET NAME CHANGE

LOTS 2-7, BLOCK 1; LOTS 1-4, BLOCK 2; LOTS 1-10, BLOCK 3; LOTS 40, 41, 43-46, BLOCK 6; LOTS 1-6, 13-15, BLOCK 11; LOTS 6-8, BLOCK 12; AND LOTS 8-12, BLOCK 13 ARE LOCATED WITHIN 300 FEET OF AN APPROVED GAS WELL DRILL SITE.



GRAPHIC SCALE

1"=150'

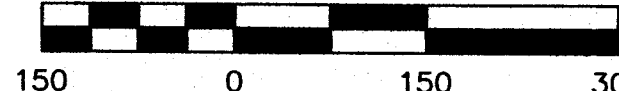

FILED FOR RECORD	20
PLAT FILED	3/29/2022
INSTRUMENT#	2022-58
DRAWER	M
COUNTY CLERK	JOHNSON COUNTY CLERK
BY	Paula Shuler
DEPUTY CLERK	

FINAL PLAT

Southpointe Phase 7

58.801 Acres out of the Seth M. Blair Survey Abstract No. 72
and Cresanto Vela Survey Abstract No. 851
City of Mansfield, Johnson County, Texas

180 Residential Lots
6 Open Space Lots

3/3/2022

PREPARED BY



Graham Associates, Inc.
CONSULTING ENGINEERS & PLANNERS
600 SIX FLAGS DRIVE, SUITE 500
ARLINGTON, TEXAS 76011 (817) 940-8535
TPOE FROM F-119/119PLS FROM 101538-00

CASE NO. 21-059

SHEET 1 OF 6

OWNER:
2021 SOUTH POINTE HOLDINGS LTD.
7676 WOODWAY, SUITE 104
HOUSTON, TX 77063
TEL: (713) 952-6767
CONTACT: GARY R. TESCH, PRESIDENT
EMAIL: GTESCH@MHINC.COM

ENGINEER:
GRAHAM ASSOCIATES, INC.
CONSULTING ENGINEERS & PLANNERS
600 SIX FLAGS DRIVE, SUITE 500
ARLINGTON, TEXAS 76011
TEL: (817) 640-8535
FAX: (817) 633-5240

AFTER RECORDING, RETURN TO THE CITY OF MANSFIELD
1200 E. BROAD STREET, MANSFIELD, TEXAS 76063

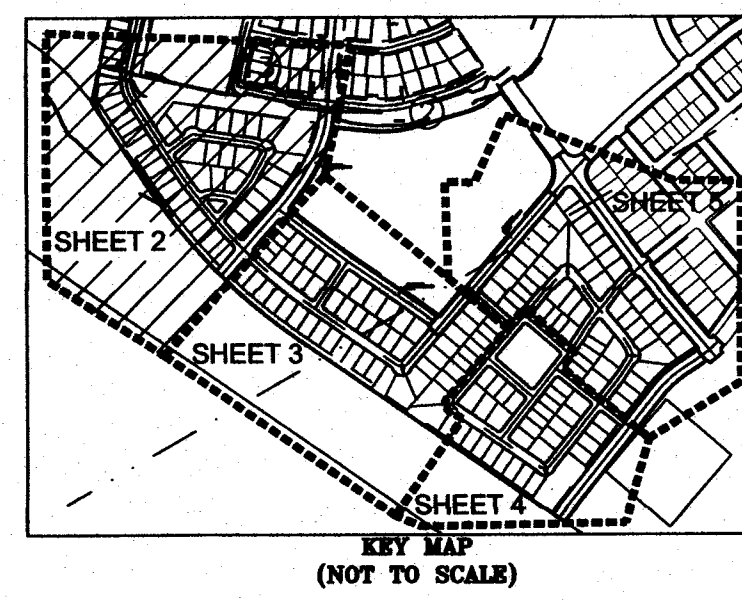
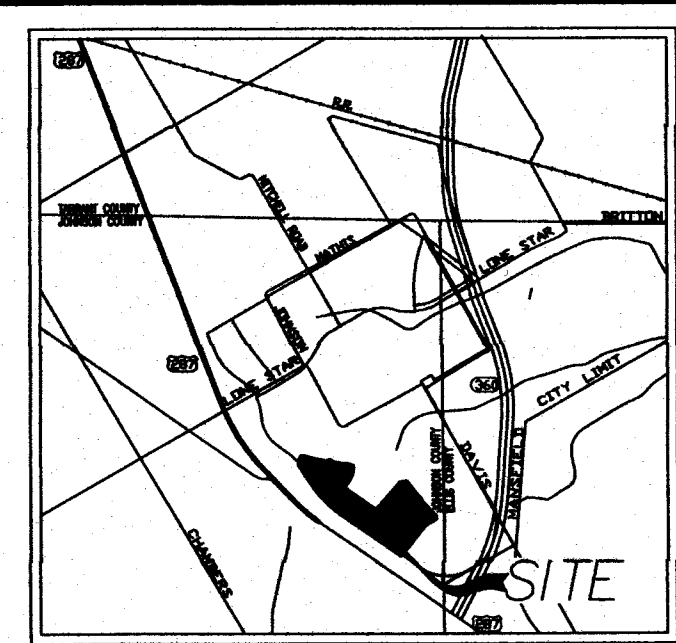
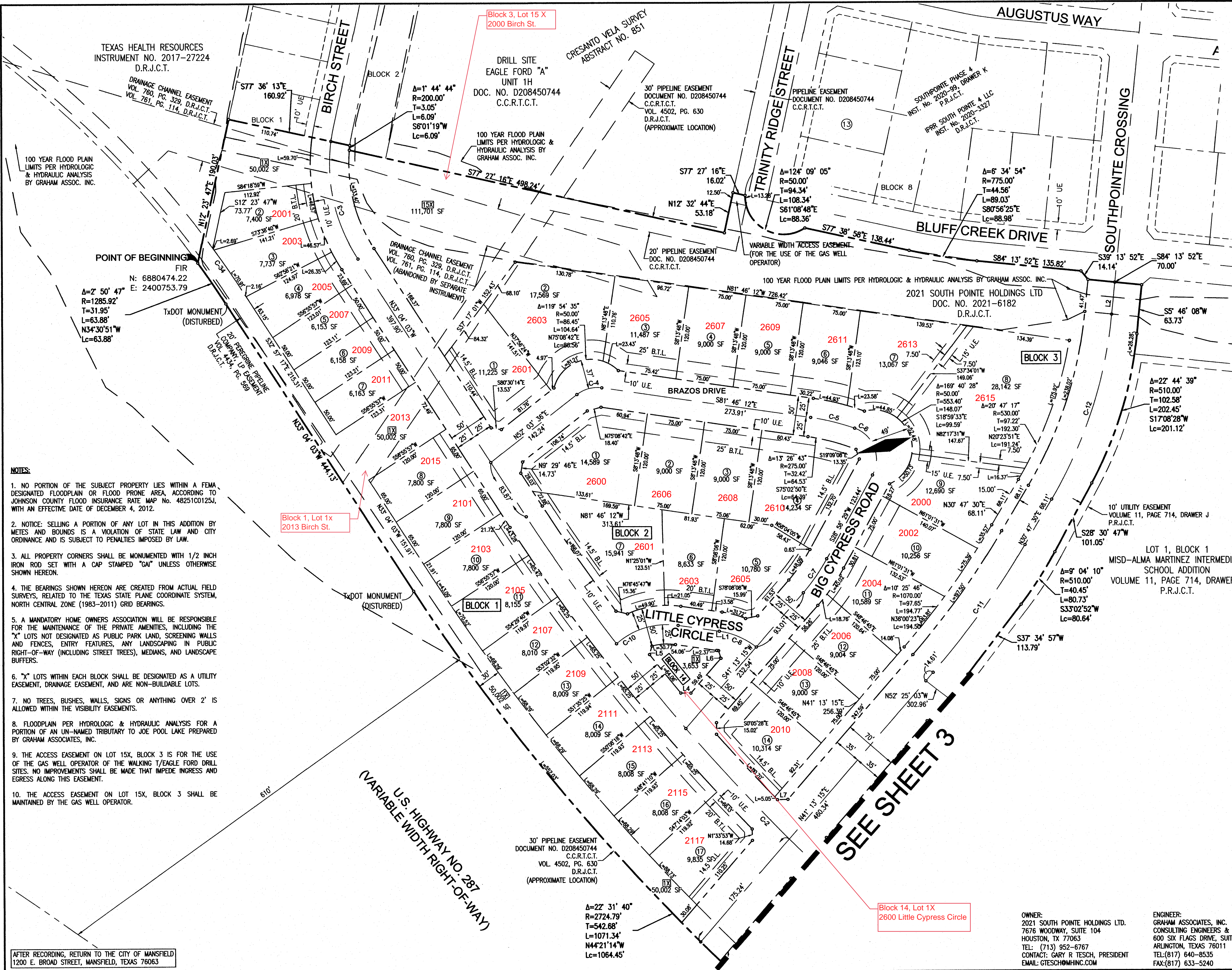

LOTS 2-7, BLOCK 1; LOTS 1-4, BLOCK 2; LOTS 1-10, BLOCK 3; LOTS 40, 41, 43-46, BLOCK 6; LOTS 1-6, 13-15, BLOCK 11; LOTS 6-8, BLOCK 12; AND LOTS 8-12, BLOCK 13 ARE LOCATED WITHIN 300 FEET OF AN APPROVED GAS WELL DRILL SITE.

LEGEND
FIR = FOUND 1/2 INCH IRON ROD WITH A CAP STAMPED "GRAHAM ASSOC INC"
C.C.R.T.C.T. = COUNTY CLERK RECORDS, TARRANT COUNTY, TEXAS
O.P.R.T.C.T. = OFFICIAL PUBLIC RECORDS, TARRANT COUNTY, TEXAS
C.C.R.J.C.T. = COUNTY CLERK RECORDS, JOHNSON COUNTY, TEXAS
C.C.R.E.C.T. = COUNTY CLERK RECORDS, ELLIS COUNTY, TEXAS
D.R.J.C.T. = DEED RECORDS, JOHNSON COUNTY, TEXAS
D.R.E.C.T. = DEED RECORDS, ELLIS COUNTY, TEXAS
B.L. = BUILD TO LINE
B.L. = BUILDING LINE
U.E. = UTILITY EASEMENT

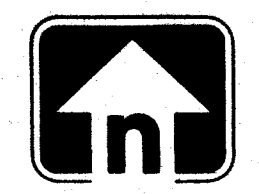
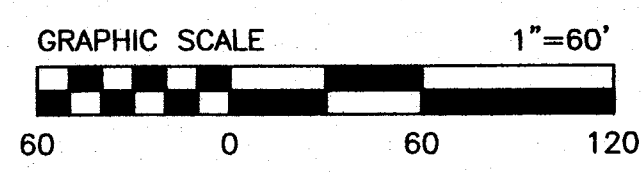
BLOCK 13 = BLOCK NUMBERS
15 = LOT NUMBERS
1X = "X" LOT

= STREET NAME CHANGE

FILED FOR RECORD 20
PLAT FILED 3/29/2022
INSTRUMENT: 2022-58
DRAWER: m SLIDE
COUNTY: BECKLEY, JOHNSON COUNTY CLERK
BY: *April Shuler* DEPUTY CLERK
DEPUTY CLERK

FINAL PLAT
Southpointe Phase 7
58.801 Acres out of the Seth M. Blair Survey Abstract No. 72
and Cresanto Vela Survey Abstract No. 851
City of Mansfield, Johnson County, Texas
180 Residential Lots
6 Open Space Lots
3/3/2022
PREPARED BY

**Graham Associates, Inc.**
CONSULTING ENGINEERS & PLANNERS
600 SIX FLAGS DRIVE, SUITE 200
ARLINGTON, TEXAS 76011 (817) 640-8535
TTYPE FIRM F-119/TBPLS FIRM: 101538-00
CASE NO. 21-059
SHEET 2 OF 6

OWNER:
2021 SOUTH POINTE HOLDINGS LTD.
7676 WOODWAY, SUITE 104
HOUSTON, TX 77063
TEL: (713) 952-6767
CONTACT: GARY R. TESCH, PRESIDENT
EMAIL: GTESCH@MHINC.COM
ENGINEER:
GRAHAM ASSOCIATES, INC.
CONSULTING ENGINEERS & PLANNERS
600 SIX FLAGS DRIVE, SUITE 200
ARLINGTON, TEXAS 76011
TEL: (817) 640-8535
FAX: (817) 633-5240

- NOTES:**
- NO PORTION OF THE SUBJECT PROPERTY LIES WITHIN A FEMA DESIGNATED FLOODPLAIN OR FLOOD PRONE AREA, ACCORDING TO JOHNSON COUNTY FLOOD INSURANCE RATE MAP NO. 48251C0125J, WITH AN EFFECTIVE DATE OF DECEMBER 4, 2012.
 - NOTICE: SELLING A PORTION OF ANY LOT IN THIS ADDITION BY METES AND BOUNDS IS A VIOLATION OF STATE LAW AND CITY ORDINANCE AND IS SUBJECT TO PENALTIES IMPOSED BY LAW.
 - ALL PROPERTY CORNERS SHALL BE MONUMENTED WITH 1/2 INCH IRON ROD SET WITH A CAP STAMPED "GA" UNLESS OTHERWISE SHOWN HEREON.
 - THE BEARINGS SHOWN HEREON ARE CREATED FROM ACTUAL FIELD SURVEYS, RELATED TO THE TEXAS STATE PLANE COORDINATE SYSTEM, NORTH CENTRAL ZONE (1983-2011) GRID BEARINGS.
 - A MANDATORY HOME OWNERS ASSOCIATION WILL BE RESPONSIBLE FOR THE MAINTENANCE OF THE PRIVATE AMENITIES, INCLUDING THE "X" LOTS NOT DESIGNATED AS PUBLIC PARK LAND, SCREENING WALLS AND FENCES, ENTRY FEATURES, ANY LANDSCAPING IN PUBLIC RIGHT-OF-WAY (INCLUDING STREET TREES), MEDIANS, AND LANDSCAPE BUFFERS.
 - "X" LOTS WITHIN EACH BLOCK SHALL BE DESIGNATED AS A UTILITY EASEMENT, DRAINAGE EASEMENT, AND ARE NON-BUILDABLE LOTS.
 - NO TREES, BUSHES, WALLS, SIGNS OR ANYTHING OVER 2' IS ALLOWED WITHIN THE VISIBILITY EASEMENTS.
 - FLOODPLAIN PER HYDROLOGIC & HYDRAULIC ANALYSIS FOR A PORTION OF AN UN-NAMED TRIBUTARY TO JOE POOL LAKE PREPARED BY GRAHAM ASSOCIATES, INC.
 - THE ACCESS EASEMENT ON LOT 15X, BLOCK 3 IS FOR THE USE OF THE GAS WELL OPERATOR OF THE WALKING T/EAGLE FORD DRILL SITES. NO IMPROVEMENTS SHALL BE MADE THAT IMPEDE INGRESS AND EGRESS ALONG THIS EASEMENT.
 - THE ACCESS EASEMENT ON LOT 15X, BLOCK 3 SHALL BE MAINTAINED BY THE GAS WELL OPERATOR.

AFTER RECORDING, RETURN TO THE CITY OF MANSFIELD
1200 E. BROAD STREET, MANSFIELD, TEXAS 76063



NOTES:

1. NO PORTION OF THE SUBJECT PROPERTY LIES WITHIN A FEMA DESIGNATED FLOODPLAIN OR FLOOD PRONE AREA, ACCORDING TO JOHNSON COUNTY FLOOD INSURANCE RATE MAP No. 48251C0125J, WITH AN EFFECTIVE DATE OF DECEMBER 4, 2012.
2. NOTICE: SELLING A PORTION OF ANY LOT IN THIS ADDITION BY METES AND BOUNDS IS A VIOLATION OF STATE LAW AND CITY ORDINANCE AND IS SUBJECT TO PENALTIES IMPOSED BY LAW.
3. ALL PROPERTY CORNERS SHALL BE MONUMENTED WITH 1/2 INCH IRON ROD SET WITH A CAP STAMPED "GAI" UNLESS OTHERWISE SHOWN HEREON.
4. THE BEARINGS SHOWN HEREON ARE CREATED FROM ACTUAL FIELD SURVEYS, RELATED TO THE TEXAS STATE PLANE COORDINATE SYSTEM, NORTH CENTRAL ZONE (1983-2011) GRID BEARINGS.
5. A MANDATORY HOME OWNERS ASSOCIATION WILL BE RESPONSIBLE FOR THE MAINTENANCE OF THE PRIVATE AMENITIES, INCLUDING THE "X" LOTS NOT DESIGNATED AS PUBLIC PARK LAND, SCREENING WALLS AND FENCES, ENTRY FEATURES, ANY LANDSCAPING IN PUBLIC RIGHT-OF-WAY (INCLUDING STREET TREES), MEDIANS, AND LANDSCAPE BUFFERS.
6. "X" LOTS WITHIN EACH BLOCK SHALL BE DESIGNATED AS A UTILITY EASEMENT, DRAINAGE EASEMENT, AND ARE NON-BUILDABLE LOTS.
7. NO TREES, BUSHES, WALLS, SIGNS OR ANYTHING OVER 2' IS ALLOWED WITHIN THE VISIBILITY EASEMENTS.
8. FLOODPLAIN PER HYDROLOGIC & HYDRAULIC ANALYSIS FOR A PORTION OF AN UN-NAMED TRIBUTARY TO JOE POOL LAKE PREPARED BY GRAHAM ASSOCIATES, INC.
9. THE ACCESS EASEMENT ON LOT 15X, BLOCK 3 IS FOR THE USE OF THE GAS WELL OPERATOR OF THE WALKING T/EAGLE FORD DRILL SITES. NO IMPROVEMENTS SHALL BE MADE THAT IMPEDE INGRESS AND EGRESS ALONG THIS EASEMENT.
10. THE ACCESS EASEMENT ON LOT 15X, BLOCK 3 SHALL BE MAINTAINED BY THE GAS WELL OPERATOR.

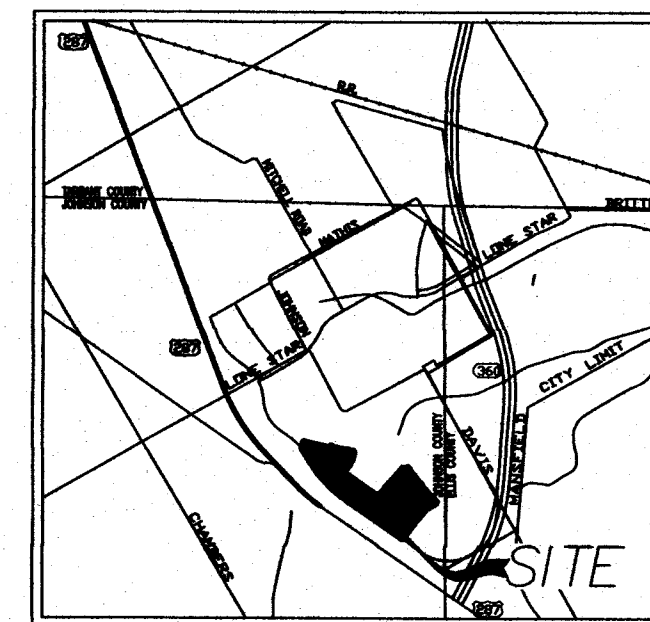

VICINITY MAP
(NOT TO SCALE)

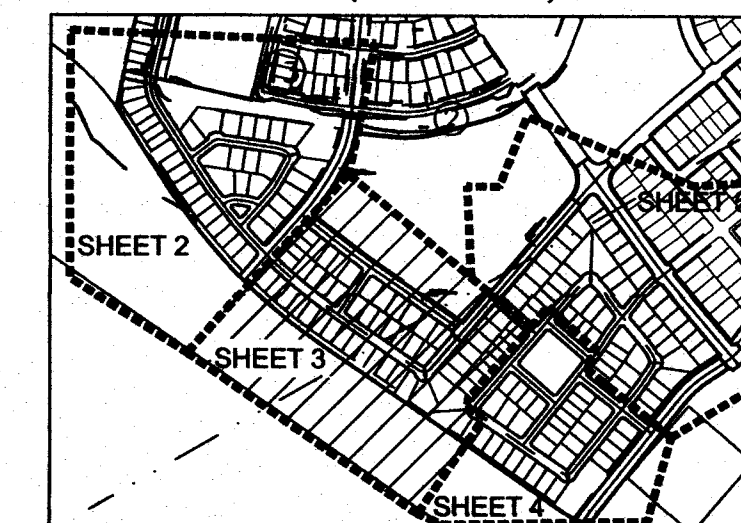

KEY MAP
(NOT TO SCALE)

LEGEND

FIR = FOUND 1/2 INCH IRON ROD WITH A CAP STAMPED "GRAHAM ASSOC INC"
C.C.R.T.C.T. = COUNTY CLERK RECORDS, TARRANT COUNTY, TEXAS
O.P.R.T.C.T. = OFFICIAL PUBLIC RECORDS, TARRANT COUNTY, TEXAS
C.C.R.C.T. = COUNTY CLERK RECORDS, JOHNSON COUNTY, TEXAS
C.C.R.E.C.T. = COUNTY CLERK RECORDS, ELLIS COUNTY, TEXAS
D.R.J.C.T. = DEED RECORDS, JOHNSON COUNTY, TEXAS
P.R.J.C.T. = PLAT RECORDS, JOHNSON COUNTY, TEXAS
D.R.E.C.T. = DEED RECORDS, ELLIS COUNTY, TEXAS
B.T.L. = BUILD TO LINE
B.L. = BUILDING LINE
U.E. = UTILITY EASEMENT

BLOCK 13 = BLOCK NUMBERS

15 = LOT NUMBERS

1X = "X" LOT

▲ = STREET NAME CHANGE

FILED FOR RECORD _____, 20__

PLAT FILED 3 29 2022

INSTRUMENT: 2022 - 58

DRAWER: YN

COUNTY: JOHNSON COUNTY CLERK

BY: [Signature] DEPUTY CLERK

DEPUTY CLERK

LOTS 2-7, BLOCK 1; LOTS 1-4, BLOCK 2; LOTS 1-10, BLOCK 3; LOTS 40, 41, 43-46, BLOCK 6; LOTS 1-6, 13-15, BLOCK 11; LOTS 6-8, BLOCK 12; AND LOTS 8-12, BLOCK 13 ARE LOCATED WITHIN 300 FEET OF AN APPROVED GAS WELL DRILL SITE.

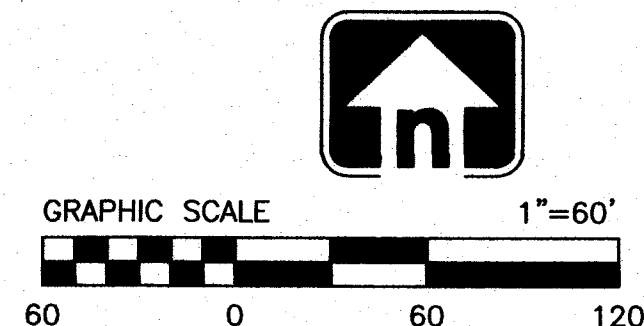

FINAL PLAT

Southpointe Phase 7

58.801 Acres out of the Seth M. Blair Survey Abstract No. 72

and Cresanto Vela Survey Abstract No. 851

City of Mansfield, Johnson County, Texas

180 Residential Lots

6 Open Space Lots

3/3/2022

PREPARED BY



Graham Associates, Inc.
CONSULTING ENGINEERS & PLANNERS
600 SIX FLAGS DRIVE, SUITE 500
ARLINGTON, TEXAS 76011 (817) 640-8535
TSP# FROM F-1107/TP#3 FROM 101338-00

OWNER:
2021 SOUTH POINTE HOLDINGS LTD.
7676 WOODWAY, SUITE 104
HOUSTON, TX 77063
TEL: (713) 952-6767
CONTACT: GARY R. TESCH, PRESIDENT
EMAIL: GTESCH@HINC.COM

ENGINEER:
GRAHAM ASSOCIATES, INC.
CONSULTING ENGINEERS & PLANNERS
600 SIX FLAGS DRIVE, SUITE 500
ARLINGTON, TEXAS 76011
TEL: (817) 640-8535
FAX: (817) 633-5240

CASE NO. 21-059

SHEET 3 OF 6

AFTER RECORDING, RETURN TO THE CITY OF MANSFIELD
1200 E. BROAD STREET, MANSFIELD, TEXAS 76063

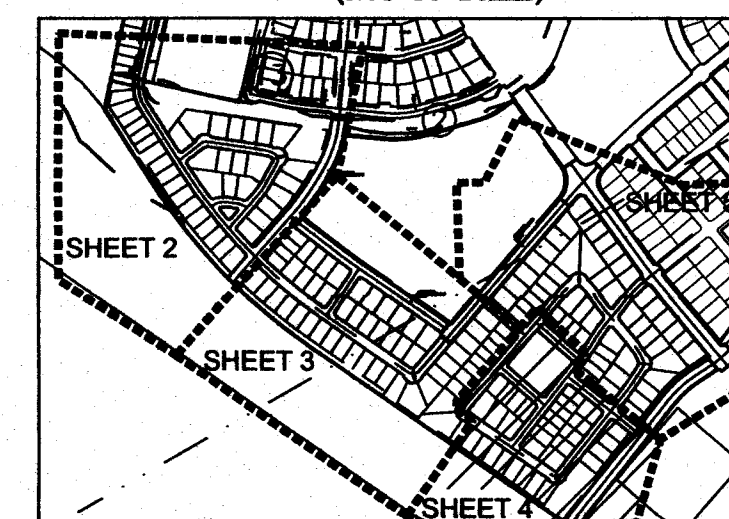
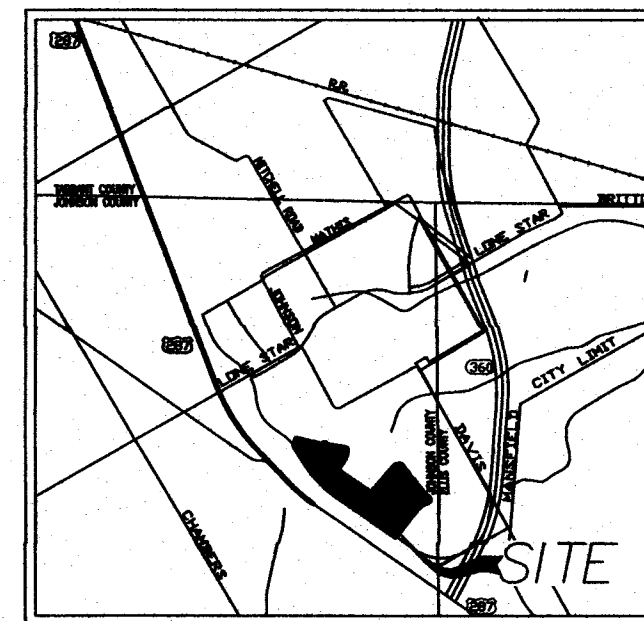

LEGEND
FIR = FOUND 1/2 INCH IRON ROD WITH A CAP STAMPED "GRAHAM ASSOC INC"
C.C.R.T.C.T. = COUNTY CLERK RECORDS, TARRANT COUNTY, TEXAS
O.P.R.T.C.T. = OFFICIAL PUBLIC RECORDS, TARRANT COUNTY, TEXAS
C.C.R.J.C.T. = COUNTY CLERK RECORDS, JOHNSON COUNTY, TEXAS
C.C.R.E.C.T. = COUNTY CLERK RECORDS, ELLIS COUNTY, TEXAS
D.R.J.C.T. = DEED RECORDS, JOHNSON COUNTY, TEXAS
D.R.E.C.T. = DEED RECORDS, ELLIS COUNTY, TEXAS
B.T.L. = BUILD TO LINE
B.L. = BUILDING LINE
U.E. = UTILITY EASEMENT

BLOCK 13 = BLOCK NUMBERS
(15) = LOT NUMBERS
1X = "X" LOT
 = STREET NAME CHANGE

NOTES:

1. NO PORTION OF THE SUBJECT PROPERTY LIES WITHIN A FEMA DESIGNATED FLOODPLAIN OR FLOOD PRONE AREA, ACCORDING TO JOHNSON COUNTY FLOOD INSURANCE RATE MAP No. 48251C01251, WITH AN EFFECTIVE DATE OF DECEMBER 4, 2012.
2. NOTICE: SELLING A PORTION OF ANY LOT IN THIS ADDITION BY METES AND BOUNDS IS A VIOLATION OF STATE LAW AND CITY ORDINANCE AND IS SUBJECT TO PENALTIES IMPOSED BY LAW.
3. ALL PROPERTY CORNERS SHALL BE MONUMENTED WITH 1/2 INCH IRON ROD SET WITH A CAP STAMPED "GAI" UNLESS OTHERWISE SHOWN HEREON.
4. THE BEARINGS SHOWN HEREON ARE CREATED FROM ACTUAL FIELD SURVEYS, RELATED TO THE TEXAS STATE PLANE COORDINATE SYSTEM, NORTH CENTRAL ZONE (1983-2011) GRID BEARINGS.
5. A MANDATORY HOME OWNERS ASSOCIATION WILL BE RESPONSIBLE FOR THE MAINTENANCE OF THE PRIVATE AMENITIES, INCLUDING THE "X" LOTS NOT DESIGNATED AS PUBLIC PARK LAND, SCREENING WALLS AND FENCES, ENTRY FEATURES, ANY LANDSCAPING IN PUBLIC RIGHT-OF-WAY (INCLUDING STREET TREES), MEDIANS, AND LANDSCAPE BUFFERS.
6. "X" LOTS WITHIN EACH BLOCK SHALL BE DESIGNATED AS A UTILITY EASEMENT, DRAINAGE EASEMENT, AND ARE NON-BUILDABLE LOTS.
7. NO TREES, BUSHES, WALLS, SIGNS OR ANYTHING OVER 2' IS ALLOWED WITHIN THE VISIBILITY EASEMENTS.
8. FLOODPLAIN PER HYDROLOGIC & HYDRAULIC ANALYSIS FOR A PORTION OF AN UN-NAMED TRIBUTARY TO JOE POOL LAKE PREPARED BY GRAHAM ASSOCIATES, INC.
9. THE ACCESS EASEMENT ON LOT 15X, BLOCK 3 IS FOR THE USE OF THE GAS WELL OPERATOR OF THE WALKING T/EAGLE FORD DRILL SITES. NO IMPROVEMENTS SHALL BE MADE THAT IMPEDE INGRESS AND EGRESS ALONG THIS EASEMENT.
10. THE ACCESS EASEMENT ON LOT 15X, BLOCK 3 SHALL BE MAINTAINED BY THE GAS WELL OPERATOR.

FILED FOR RECORD	20
PLAT REC	PLAT FILED 3/29/2022
INSTRUMENT#	2022-58
DRAWER	M SLIDE
COUNTY	JOHNSON COUNTY CLERK
BY	Becky Ivey, DEPUTY CLERK
DEPUTY CLERK	

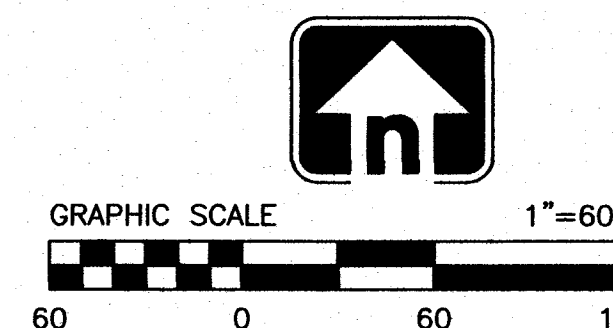

FINAL PLAT

Southpointe Phase 7

58.801 Acres out of the Seth M. Blair Survey Abstract No. 72
and Cresanto Vela Survey Abstract No. 851
City of Mansfield, Johnson County, Texas
180 Residential Lots
6 Open Space Lots

3/3/2022
PREPARED BY



Graham Associates, Inc.
CONSULTING ENGINEERS & PLANNERS
600 SIX FLAGS DRIVE, SUITE 500
ARLINGTON, TEXAS 76011 (817) 640-8535
TPOE FROM: F-11917/PLS FROM: 101538-00

OWNER:
2021 SOUTH POINTE HOLDINGS LTD.
7676 WOODWAY, SUITE 104
HOUSTON, TX 77063
TEL: (713) 952-6767
CONTACT: GARY R TESCH, PRESIDENT
EMAIL: GTESCH@HINC.COM

ENGINEER:
GRAHAM ASSOCIATES, INC.
CONSULTING ENGINEERS & PLANNERS
600 SIX FLAGS DRIVE, SUITE 500
ARLINGTON, TEXAS 76011
TEL: (817) 640-8535
FAX: (817) 633-5240

CASE NO. 21-059

SHEET 4 OF 6

AFTER RECORDING, RETURN TO THE CITY OF MANSFIELD
1200 E. BROAD STREET, MANSFIELD, TEXAS 76063

LOT 1, BLOCK 1
MISD-ALMA MARTINEZ INTERMEDIATE
SCHOOL ADDITION
VOLUME 11, PAGE 714, DRAWER J
P.R.J.C.T.

LOT 1, BLOCK 1
MISD-BRENDA NORWOOD
ELEMENTARY SCHOOL ADDITION
VOL. 11, PG. 717, DRAWER J
P.R.J.C.T.

$\Delta=102' 12' 33''$
 $R=25.40'$
 $T=31.48'$
 $L=45.31'$
 $S87^{\circ}05'01''E$
 $Lc=39.54'$

$\Delta=0' 56' 05''$
 $R=4470.00'$
 $T=36.47'$
 $L=72.93'$
 $N41^{\circ}20'47''E$
 $Lc=72.93'$

SOUTHPOINTE PHASE 8A
INSTRUMENT NO. 2021-42
P.R.J.C.T.

4.70 AC DRILL PAD SITE
DOC. NO. D208450744
C.C.R.T.C.T.

LEGEND
FIR = FOUND 1/2 INCH IRON ROD WITH A CAP STAMPED "GRAHAM ASSOC INC"
C.C.R.T.C.T. = COUNTY CLERK RECORDS, TARRANT COUNTY, TEXAS
O.P.R.T.C.T. = OFFICIAL PUBLIC RECORDS, TARRANT COUNTY, TEXAS
C.C.R.E.C.T. = COUNTY CLERK RECORDS, JOHNSON COUNTY, TEXAS
C.C.R.E.C.T. = COUNTY CLERK RECORDS, ELLIS COUNTY, TEXAS
D.R.J.C.T. = DEED RECORDS, JOHNSON COUNTY, TEXAS
P.R.J.C.T. = PLAT RECORDS, JOHNSON COUNTY, TEXAS
D.R.E.C.T. = DEED RECORDS, ELLIS COUNTY, TEXAS
B.T.L. = BUILD TO LINE
B.L. = BUILDING LINE
U.E. = UTILITY EASEMENT

BLOCK 13 = BLOCK NUMBERS

(15) = LOT NUMBERS

[X] = "X" LOT

◆ = STREET NAME CHANGE

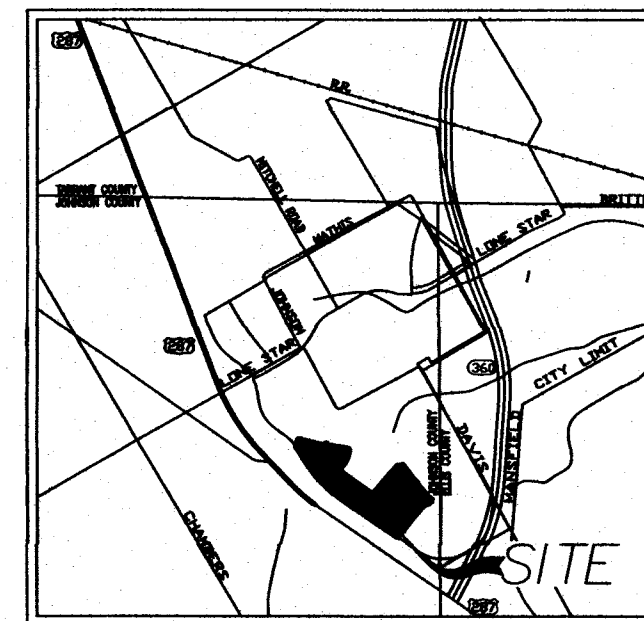

VICINITY MAP
(NOT TO SCALE)

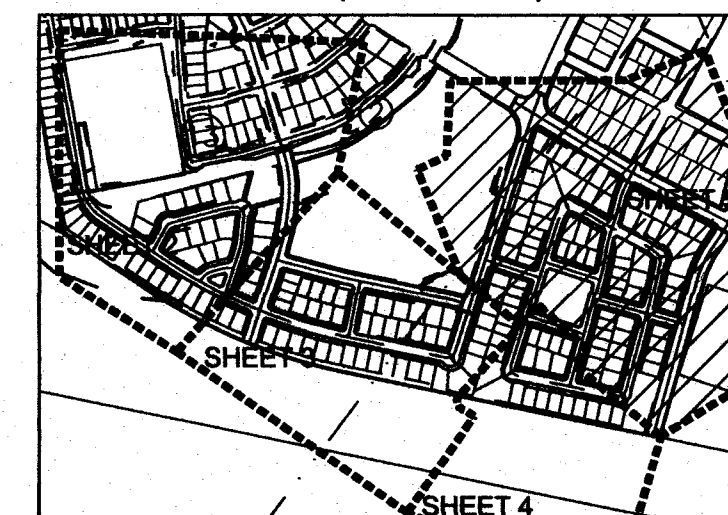

KEY MAP
(NOT TO SCALE)

NOTES:

- NO PORTION OF THE SUBJECT PROPERTY LIES WITHIN A FEMA DESIGNATED FLOODPLAIN OR FLOOD PRONE AREA, ACCORDING TO JOHNSON COUNTY FLOOD INSURANCE RATE MAP No. 48251C0125J, WITH AN EFFECTIVE DATE OF DECEMBER 4, 2012.
- NOTICE: SELLING A PORTION OF ANY LOT IN THIS ADDITION BY METES AND BOUNDS IS A VIOLATION OF STATE LAW AND CITY ORDINANCE AND IS SUBJECT TO PENALTIES IMPOSED BY LAW.
- ALL PROPERTY CORNERS SHALL BE MONUMENTED WITH 1/2 INCH IRON ROD SET WITH A CAP STAMPED "GAI" UNLESS OTHERWISE SHOWN HEREON.
- THE BEARINGS SHOWN HEREON ARE CREATED FROM ACTUAL FIELD SURVEYS, RELATED TO THE TEXAS STATE PLANE COORDINATE SYSTEM, NORTH CENTRAL ZONE (1983-2011) GRID BEARINGS.
- A MANDATORY HOME OWNERS ASSOCIATION WILL BE RESPONSIBLE FOR THE MAINTENANCE OF THE PRIVATE AMENITIES, INCLUDING THE "X" LOTS NOT DESIGNATED AS PUBLIC PARK LAND, SCREENING WALLS AND FENCES, ENTRY FEATURES, ANY LANDSCAPING IN PUBLIC RIGHT-OF-WAY (INCLUDING STREET TREES), MEDIANS, AND LANDSCAPE BUFFERS.
- "X" LOTS WITHIN EACH BLOCK SHALL BE DESIGNATED AS A UTILITY EASEMENT, DRAINAGE EASEMENT, AND ARE NON-BUILDABLE LOTS.
- NO TREES, BUSHES, WALLS, SIGNS OR ANYTHING OVER 2' IS ALLOWED WITHIN THE VISIBILITY EASEMENTS.
- FLOODPLAIN PER HYDROLOGIC & HYDRAULIC ANALYSIS FOR A PORTION OF AN UN-NAMED TRIBUTARY TO JOE POOL LAKE PREPARED BY GRAHAM ASSOCIATES, INC.
- THE ACCESS EASEMENT ON LOT 15X, BLOCK 3 IS FOR THE USE OF THE GAS WELL OPERATOR OF THE WALKING T/EAGLE FORD DRILL SITES. NO IMPROVEMENTS SHALL BE MADE THAT IMPEDE INGRESS AND EGRESS ALONG THIS EASEMENT.
- THE ACCESS EASEMENT ON LOT 15X, BLOCK 3 SHALL BE MAINTAINED BY THE GAS WELL OPERATOR.

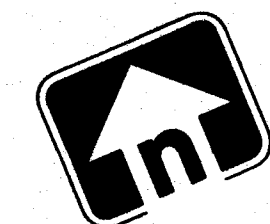

GRAPHIC SCALE 1"=60'
60 0 60 120

FINAL PLAT

Southpointe Phase 7

58.801 Acres out of the Seth M. Blair Survey Abstract No. 72
and Cresanto Vela Survey Abstract No. 851
City of Mansfield, Johnson County, Texas
180 Residential Lots
6 Open Space Lots

3/3/2022

PREPARED BY



Graham Associates, Inc.
CONSULTING ENGINEERS & PLANNERS
800 SIX FLAGS DRIVE, SUITE 600
ARLINGTON, TEXAS 76011 (817) 440-8535
TOLL FREE: 1-877-440-8535

OWNER:
2021 SOUTH POINTE HOLDINGS LTD.
7676 WOODWAY, SUITE 104
HOUSTON, TX 77063
TEL: (713) 952-6767
CONTACT: GARY R TESCH, PRESIDENT
EMAIL: GITESCH@HMC.COM

ENGINEER:
GRAHAM ASSOCIATES, INC.
CONSULTING ENGINEERS & PLANNERS
600 SIX FLAGS DRIVE, SUITE 500
ARLINGTON, TEXAS 76011
TEL: (817) 640-8535
FAX: (817) 633-5240

CASE NO. 21-059

SHEET 5 OF 6

LOTS 2-7, BLOCK 1; LOTS 1-4, BLOCK 2; LOTS 1-10, BLOCK 3; LOTS 40, 41, 43-46, BLOCK 6; LOTS 1-6, 13-15, BLOCK 11; LOTS 6-8, BLOCK 12; AND LOTS 8-12, BLOCK 13 ARE LOCATED WITHIN 300 FEET OF AN APPROVED GAS WELL DRILL SITE.

AFTER RECORDING, RETURN TO THE CITY OF MANSFIELD
1200 E. BROAD STREET, MANSFIELD, TEXAS 76063

FILED FOR RECORD

PLAT RECORDED IN VOLUME

PLAT FILED 3/29/2022
COUNTY C INSTRUMENT: 2022-58
DRAWER m SUDE
BECKY IVEY, JOHNSON COUNTY CLERK
DEPUTY CLE BY *[Signature]*

LEGAL DESCRIPTION

WHEREAS, 2021 South Pointe Holdings LTD., acting by and through the undersigned, it's duly authorized agent, is the sole owner of an 58.801 acre tract of land located in the Seth M. Blair Survey Abstract No. 72 and Cresanto Vela Survey Abstract No. 851, City of Mansfield, Johnson County, and recorded in Instrument No. 2021-6182, Deed Records, Tarrant County, Texas, being more particularly described as follows:

BEGINNING at a found 1/2 inch iron rod with a cap stamped "GRAHAM ASSOC INC" (GAI), being in the existing public east right-of-way line of U.S. Highway No. 287 (Variable Width Right-Of-Way) and being in the west line of said 2021 South Pointe Holdings LTD. tract and being the south corner of a tract of land conveyed to Texas Health Resources as recorded in Instrument No. 2017-27224, Deed Records, Johnson County, Texas;

THENCE North 12°23'47" East, along the southeast line of said Texas Health Resources tract, a distance of 190.03 feet to a set 1/2 inch iron rod with a "GAI" cap, being the southwest corner of Lot 1, Block 1, Southpointe Phase 4, as recorded in Instrument No. 2020-99, Drawer K, Plat Records, Johnson County, Texas;

THENCE South 77°36'13" East, leaving said southeast line, along the south line of said Southpointe Phase 4, a distance of 160.92 feet to a set 1/2 inch iron rod with a "GAI" cap, being in the west line of Lot 1X, Block 2, of said Southpointe Phase 4, for the beginning of a non-tangent curve to the left having a radius of 200.00 feet, a central angle of 1°44'44", and a long chord which bears South 06°01'19" West, 6.09 feet;

THENCE along said non-tangent curve to the left, along said west line and continuing along said south line, an arc length of 6.09 feet to a set 1/2 inch iron rod with a "GAI" cap, being the southwest corner of said Lot 1X;

THENCE South 77°27'16" East, continuing along said south line, a distance of 498.24 feet to a set 1/2 inch iron rod with a "GAI" cap;

THENCE North 12°32'44" East, a distance of 53.18 feet to a set 1/2 inch iron rod with a "GAI" cap, being in the south line of Lot 1X, Block 20, of said Southpointe Phase 4;

THENCE South 77°27'16" East, along the south line of said Lot 1X, Block 20, a distance of 16.02 feet to a set 1/2 inch iron rod with a "GAI" cap, being in the existing south right-of-way line of Bluff Creek Drive (being a 50 foot right-of-way), for the beginning of a non-tangent curve to the left having a radius of 50.00 feet, a central angle of 124°09'05", and a long chord which bears South 61°08'48" East, 88.36 feet;

THENCE along said non-tangent curve to the left, along said existing south right-of-way line and the south line of said Southpointe Phase 4, being a common line, an arc length of 108.34 feet to a set 1/2 inch iron rod with a "GAI" cap;

THENCE South 77°38'58" East, continuing along said common line, a distance of 138.44 feet to a set 1/2 inch iron rod with a "GAI" cap, for the beginning of a tangent curve to the left having a radius of 775.00 feet, a central angle of 6°34'54", and a long chord which bears South 80°56'25" East, 88.98 feet;

THENCE along said tangent curve to the left, an arc length of 89.03 feet to a set 1/2 inch iron rod with a "GAI" cap;

THENCE South 84°13'52" East, a distance of 135.82 feet to a set 1/2 inch iron rod with a "GAI" cap;

THENCE South 39°13'52" East, a distance of 14.14 feet to a set 1/2 inch iron rod with a "GAI" cap;

THENCE South 84°13'52" East, a distance of 70.00 feet to a set 1/2 inch iron rod with a "GAI" cap;

THENCE South 05°46'08" West, leaving said common line, a distance of 63.73 feet to a set 1/2 inch iron rod with a "GAI" cap, for the beginning of a tangent curve to the right having a radius of 510.00 feet, a central angle of 22°44'39", and a long chord which bears South 17°08'28" West, 201.12 feet;

THENCE along said tangent curve to the right, an arc length of 26.28 feet passing the northwest corner of Lot 1, Block 1, MISD-ALMA MARTINEZ INTERMEDIATE SCHOOL ADDITION, as recorded in Volume 11, Page 714, Drawer J, Plat Records, Johnson County, Texas, continuing on for a total arc length of 202.45 feet to a set 1/2 inch iron rod with a "GAI" cap;

THENCE South 28°30'47" West, along the northwest line of said Lot 1, a distance of 101.05 feet to a set 1/2 inch iron rod with a "GAI" cap, for the beginning of a tangent curve to the right having a radius of 510.00 feet, a central angle of 9°04'10", and a long chord which bears South 33°02'52" West, 80.64 feet;

THENCE along said tangent curve to the right, and continuing along said northwest line, an arc length of 80.73 feet to a set 1/2 inch iron rod with a "GAI" cap;

THENCE South 37°34'57" West, continuing along said northwest line, a distance of 113.79 feet to a set 1/2 inch iron rod with a "GAI" cap;

THENCE South 07°25'03" East, continuing along said northwest line, a distance of 14.14 feet to a set 1/2 inch iron rod with a "GAI" cap;

THENCE South 52°25'03" East, along the southwest line of said Lot 1, a distance of 254.73 feet to a set 1/2 inch iron rod with a "GAI" cap, for the beginning of a tangent curve to the left having a radius of 2,229.79 feet, a central angle of 3°10'44", and a long chord which bears South 54°00'25" East, 123.70 feet;

THENCE along said tangent curve to the left, and continuing along said southwest line, an arc length of 123.71 feet to a set 1/2 inch iron rod with a "GAI" cap;

THENCE South 55°35'47" East, continuing along said southwest line, a distance of 487.43 feet to a set 1/2 inch iron rod with a "GAI" cap, for the beginning of a tangent curve to the right having a radius of 580.00 feet, a central angle of 05°23'47", and a long chord which bears South 52°53'25" East, 54.61 feet;

THENCE along said tangent curve to the right and continuing along said southwest line, an arc length of 54.63 feet to a set 1/2 inch iron rod with a "GAI" cap;

THENCE South 40°48'35" West, leaving said southwest line, a distance of 60.01 feet to a set 1/2 inch iron rod with a "GAI" cap;

THENCE South 06°00'14" East, a distance of 13.74 feet to a set 1/2 inch iron rod with a "GAI" cap;

THENCE South 49°07'16" East, a distance of 60.00 feet to a set 1/2 inch iron rod with a "GAI" cap;

THENCE North 40°52'44" East, a distance of 246.30 feet to a set 1/2 inch iron rod with a "GAI" cap;

THENCE North 85°52'44" East, a distance of 14.14 feet to a set 1/2 inch iron rod with a "GAI" cap;

THENCE North 40°52'44" East, a distance of 50.00 feet to a set 1/2 inch iron rod with a "GAI" cap;

THENCE North 04°07'16" East, a distance of 14.14 feet to a set 1/2 inch iron rod with a "GAI" cap;

THENCE North 40°52'44" East, a distance of 593.25 feet to a set 1/2 inch iron rod with a "GAI" cap, for the beginning of a tangent curve to the left having a radius of 4,470.00 feet, a central angle of 00°56'05", and a long chord which bears North 41°20'47" East, 72.93 feet;

THENCE along said tangent curve to the left, an arc length of 72.93 feet to a set 1/2 inch iron rod with a "GAI" cap, for the beginning of a reverse curve to the right having a radius of 25.40 feet, a central angle of 102°12'33", and a long chord which bears South 87°05'01" East, 39.54 feet;

THENCE along said reverse curve to the right, an arc length of 45.31 feet to a set 1/2 inch iron rod with a "GAI" cap;

THENCE South 35°58'47" East, a distance of 426.87 feet to a set 1/2 inch iron rod with a "GAI" cap, for the beginning of a tangent curve to the left having a radius of 2,040.00 feet, a central angle of 01°36'21", and a long chord which bears South 36°46'57" East, 57.17 feet;

THENCE along said tangent curve to the left, an arc length of 57.17 feet to a set 1/2 inch iron rod with a "GAI" cap;

THENCE South 06°53'35" West, a distance of 14.14 feet to a set 1/2 inch iron rod with a "GAI" cap;

THENCE South 38°29'16" East, a distance of 50.07 feet to a set 1/2 inch iron rod with a "GAI" cap;

THENCE South 84°00'31" East, a distance of 14.24 feet to a set 1/2 inch iron rod with a "GAI" cap, for the beginning of a non-tangent curve to the right having a radius of 2,040 feet, a central angle of 00°26'20", and a long chord which bears South 39°46'14" East, 15.63 feet;

THENCE along said non-tangent curve to the left, an arc length of 15.63 feet to a set 1/2 inch iron rod with a "GAI" cap;

THENCE South 38°59'24" East, a distance of 449.43 feet to a set 1/2 inch iron rod with a "GAI" cap;

THENCE South 07°12'16" West, a distance of 13.59 feet to a set 1/2 inch iron rod with a "GAI" cap;

THENCE South 39°59'05" East, a distance of 70.23 feet to a set 1/2 inch iron rod with a "GAI" cap, for the beginning of a non-tangent curve to the right having a radius of 610.00 feet, a central angle of 2°26'32", and a long chord which bears South 55°35'09" West, 26.00 feet;

THENCE along said non-tangent curve to the right, an arc length of 26.00 feet to a set 1/2 inch iron rod with a "GAI" cap;

THENCE South 56°48'25" West, a distance of 87.69 feet to a set 1/2 inch iron rod with a "GAI" cap, for the beginning of a tangent curve to the left having a radius of 540.00 feet, a central angle of 18°18'05", and a long chord which bears South 47°39'23" West, 171.75 feet;

THENCE along said tangent curve to the left, an arc length of 172.49 feet to a set 1/2 inch iron rod with a "GAI" cap;

THENCE South 38°30'20" West, a distance of 793.55 feet to a set 1/2 inch iron rod with a "GAI" cap;

THENCE South 08°32'44" East, a distance of 13.63 feet to a set 1/2 inch iron rod with a "GAI" cap, being in said east right-of-way line of U.S. Highway No. 287 and said west line of said 2021 South Pointe Holdings LTD. tract, being a common line;

THENCE North 55°35'47" West, along said common line, a distance of 1663.11 feet to a TxDOT Monument (Broken), for the beginning of a tangent curve to the right having a radius of 2,724.79 feet, a central angle of 22°31'40", and a long chord which bears North 44°21'14" West, 1064.45 feet;

THENCE along said tangent curve to the right, and continuing along said common line, an arc length of 1071.34 feet to a TxDOT Monument (Broken);

THENCE North 33°04'03" West, a distance of 444.13 feet to a TxDOT Monument (Broken), for the beginning of a tangent curve to the left having a radius of 1,285.92 feet, a central angle of 2°50'47", and a long chord which bears North 34°30'51" West, 63.88 feet;

THENCE along said tangent curve to the left, an arc length of 63.88 feet to the POINT OF BEGINNING and CONTAINING 2,561,371 square feet, 58.801 acres of land, more or less.

NOW THEREFORE KNOW ALL MEN BY THESE PRESENTS:

That, 2021 South Pointe Holdings LTD., being the sole owner of the above described parcel, acting by and through the undersigned, it's duly authorized agent, does hereby adopt the herein above described property as Southpointe Phase 7, an addition to the City of Mansfield, Johnson County, Texas and does dedicate to the public use the streets and easements as shown thereon.

2021 South Pointe Holdings LTD.,

Signature

GARY R. TESCH
PRESIDENT

Name, Title

STATE OF Texas:
COUNTY OF Harris:

BEFORE ME, the undersigned, a Notary Public in and for said County and State, on this day personally appeared GARY R. TESCH know to me the person whose name is subscribed to the forgoing instrument and acknowledged to me that he executed the same for the purposes and consideration therein expressed, and in the capacity stated.

GIVEN UNDER MY HAND AND SEAL OF OFFICE, this the 14th day of March, 2022

Notary Public in and for the State of Texas

My commission expires 11-9-2025

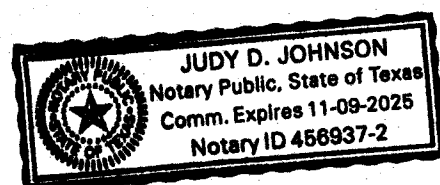

SURVEYOR'S CERTIFICATE

This is to certify that I, MICHAEL L. PETERSON, a Registered Professional Land Surveyor of the State of Texas, having plotted the above subdivision from an actual survey on the ground, and that all lot corners, and angle points, and points of curve shall be properly marked on the ground, and that this plat correctly represents that survey made by me or under my direction and supervision.

Michael L. Peterson 03/03/2022

MICHAEL L. PETERSON
Texas Registration No. 5999

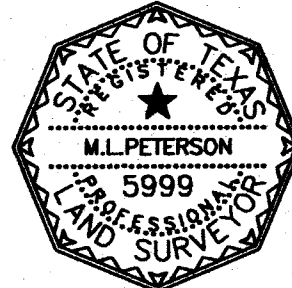

STATE OF Texas:
COUNTY OF Dallas:

BEFORE ME, the undersigned authority, a Notary Public in and for the State of Texas, on this day personally appeared MICHAEL L. PETERSON, known to me to be the person whose name is subscribed to the foregoing instrument and acknowledge to me that he executed the same in and for the purpose and consideration therein expressed, and in the capacity therein stated.

GIVEN UNDER MY HAND AND SEAL OF OFFICE this 3rd day of March, 2022

Audrea H. Little
Notary Public in and for the State of Texas

My commission expires 4-27-2025

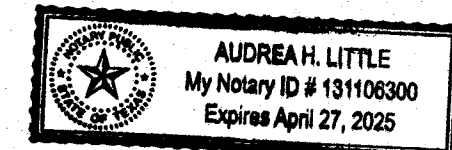

APPROVED BY THE CITY OF MANSFIELD	
<u>March 22, 2022</u>	
<u>[Signature]</u>	
APPROVED BY:	PLANNING & ZONING COMMISSION CHAIRMAN
<u>March 22, 2022</u>	<u>[Signature]</u>
APPROVED BY:	PLANNING & ZONING SECRETARY
<u>[Signature]</u>	<u>[Signature]</u>

FILED FOR	PLAT FILED <u>3/29/2022</u>
PLAT RECO	INSTRUMENT# 2022 - <u>58</u>
DRAWER	<u>mm</u> SLIDE
BECKY IVEY, JOHNSON COUNTY CLERK	
COUNTY CL BY <u>April Phuller</u>	DEPUTY CLERK
DEPUTY CLERK	

LOTS 2-7, BLOCK 1; LOTS 1-4, BLOCK 2; LOTS 1-10, BLOCK 3; LOTS 40, 41, 43-46, BLOCK 6; LOTS 1-6, 13-15 BLOCK 11; LOTS 6-8, BLOCK 12; AND LOTS 8-12, BLOCK 13 ARE LOCATED WITHIN 300 FEET OF AN APPROVED GAS WELL DRILL SITE.

CONDITIONS OF ACCEPTANCE OF DRAINAGE AND FLOODWAY EASEMENTS

THIS PLAT IS PROPOSED BY THE OWNERS OF PROPERTIES DESCRIBED HEREIN (HEREINAFTER REFERRED TO AS "PROPERTY OWNERS") AND IS APPROVED BY THE CITY OF MANSFIELD SUBJECT TO THE FOLLOWING CONDITIONS WHICH SHALL BE BINDING UPON THE PROPERTY OWNERS, HIS HEIRS, GRANTEEES, SUCCESSORS AND ASSIGNS.

NO OBSTRUCTION TO THE FLOW OF STORMWATER RUN-OFF SHALL BE PERMITTED BY FILLING OR BY CONSTRUCTION OF ANY TYPE OF DAM, BUILDING, BRIDGE, FENCE, OR ANY OTHER STRUCTURE WITHIN THE DRAINAGE EASEMENT SHOWN HEREIN ON THIS PLAT, UNLESS APPROVED BY THE CITY OF MANSFIELD. PROVIDED, HOWEVER, IT IS UNDERSTOOD THAT IN THE EVENT IT BECOMES NECESSARY FOR THE CITY OF MANSFIELD TO ERECT DRAINAGE FACILITIES IN ORDER TO IMPROVE THE STORM DRAINAGE THAT MAY BE OCCASIONED BY THE STREETS AND ALLEYS IN OR ADJACENT TO THE SUBDIVISION, THEN IN SUCH EVENT, THE CITY OF MANSFIELD SHALL HAVE THE RIGHT TO ENTER SAID DRAINAGE EASEMENT AT ANY POINT OR POINTS TO ERECT, CONSTRUCT AND MAINTAIN ANY FACILITY DEEMED NECESSARY FOR DRAINAGE PURPOSES.

THE PROPERTY OWNERS WILL BE RESPONSIBLE FOR MAINTAINING SAID DRAINAGE EASEMENT. THE PROPERTY OWNERS SHALL KEEP SAID DRAINAGE EASEMENT CLEAN AND FREE OF DEBRIS, SILT, HIGH WEEDS, AND ANY SUBSTANCE WHICH WOULD RESULT IN UNSANITARY OR UNDESIRABLE CONDITIONS. THE CITY OF MANSFIELD SHALL HAVE THE RIGHT OF INGRESS AND EGRESS FOR THE PURPOSE OF INSPECTING AND SUPERVISING MAINTENANCE WORK DONE BY THE PROPERTY OWNERS. IF AT ANY TIME THE PROPERTY OWNERS FAIL TO SATISFY ANY OF THEIR FOREMENTIONED RESPONSIBILITIES OR OBLIGATIONS, THE CITY OF MANSFIELD, UPON TEN (10) DAYS PRIOR NOTICE TO THE OWNERS, MAY ENTER SAID DRAINAGE EASEMENT AT ANY POINT OR POINTS TO PERFORM MAINTENANCE OR CLEAN-UP, AND BILL THE PROPERTY OWNERS THE COST INCURRED, OR PLACE A LIEN ON SAID PROPERTIES IF THE BILL IS NOT PAID WITHIN THIRTY (30) DAYS OF ITS MAILING.

SAID DRAINAGE EASEMENT, AS IN THE CASE OF ALL DRAINAGE EASEMENTS, IS SUBJECT TO STORMWATER OVERFLOW AND EROSION TO AN EXTENT WHICH CANNOT BE SPECIFICALLY DEFINED. THE CITY OF MANSFIELD SHALL NOT BE HELD LIABLE FOR ANY DAMAGES RESULTING FROM THE OCCURRENCE OF THESE NATURAL PHENOMENA OR THE FAILURE OF ANY FACILITIES WITHIN SAID DRAINAGE EASEMENT. FURTHER, THE CITY OF MANSFIELD WILL NOT BE RESPONSIBLE FOR EROSION CONTROL OR ANY DAMAGE TO PRIVATE PROPERTIES OR PERSONS RESULTING FROM THE FLOW OF WATER WITHIN SAID DRAINAGE EASEMENT AND PROPERTIES.

Parcel Line Table

LINE #	LENGTH	DIRECTION
L1	54.06'	N81° 46' 12"W
L2	41.47'	N5° 46' 08"E
L3	9.40'	N35° 58' 47"W
L4	13.02'	S89° 24' 13"E
L5	11.57'	S16° 14' 57"W
L6	10.39'	N17° 25' 34"W
L7	13.57'	N88° 28' 45"E
L8	14.14'	S85° 52' 44"W
L9	14.14'	S6° 29' 40"E
L10	60.01'	S40° 48' 35"W
L11	13.74'	S6° 00' 14"E
L12	60.00'	S49° 07' 16"E
L13	14.14'	S83° 30' 20"W
L14	87.69'	S56° 48' 25"W
L15	198.56'	S38° 30' 20"W
L17	25.00'	N36° 37' 26"E

CURVE TABLE

CURVE #	Δ	RADIUS	TANGENT	LENGTH	LCB	LCD
C-1	83° 31' 29"	42.50'	37.95'	61.96'	S82° 38' 29"W	56.61'
C-2	22° 31' 44"	2545.00'	506.90'	1000.70'	N44° 19' 55"W	994.26'
C-3	40° 34' 30"	225.00'	83.17'	159.34'	N12° 46' 48"W	156.03'
C-4	46° 10' 12"	42.50'	18.11'	34.25'	N75° 08' 42"E	33.33'
C-5	11° 14' 41"	300.00'	29.53'	58.88'	S76° 08' 51"E	58.78'
C-6	99° 30' 00"	42.50'	50.20'	73.81'	S20° 46' 31"E	64.87'
C-7	12° 14' 46"	250.00'	26.82'	53.43'	S35° 05' 52"W	53.33'
C-8	30° 08' 54"	100.00'	26.93'	52.62'	N66° 41' 45"W	52.01'
C-9	18° 18' 05"	630.00'	101.48'	201.23'	S47° 39' 23"W	200.38'
C-10	49° 21' 07"	100.00'	45.94'	86.14'	S73° 33' 15"W	83.50'
C-11	10° 25' 46"	1120.00'	102.22'	203.87'	N36° 00' 23"E	203.59'
C-12	25° 01' 22"	580.00'	128.70'	253.30'	N18° 16' 49"E	251.29'
C-13	5° 20' 31"	550.00'	25.66'	51.28'	N52° 55' 03"W	51.26'
C-14	2° 47' 22"	520.00'	12.66'	25.32'	S55° 24' 44"W	25.31'
C-15	3° 10' 44"	2259.79'	62.71'	125.38'	N54° 00' 25"W	125.36'
C-16	2° 10' 36"	575.00'	10.92'	21.85'	N55° 43' 07"E	21.84'
C-17	85° 53' 52"	42.50'	39.56'	63.72'	N81° 27' 16"E	57.91'
C-18	5° 40' 13"	1030.00'	51.01'	101.94'	N35° 40' 14"E	101.89'
C-19	56° 34' 14"	42.50'	22.87'	41.96'	N4° 33' 00"E	40.28'
C-20	16° 15' 17"	300.00'	42.84'	85.11'	N31° 51' 45"W	84.82'
C-21	4° 00' 37"	2295.00'	80.35'	160.63'	N37° 59' 05"W	160.60'
C-22	13° 39' 44"	300.00'	35.94'	71.53'	N42° 48' 39"W	71.37'
C-23	75° 49' 01"	42.50'	33.10'	56.24'	N87° 33' 02"W	52.22'
C-24	13° 39' 44"	300.00'	35.94'	71.53'	S47° 42' 36"W	71.37'
C-25	96° 28' 31"	42.50'	47.60'	71.56'	S7° 21' 32"E	63.40'
C-26	5° 40' 13"	750.00'	37.14'	74.22'	N35° 40' 14"E	74.19'
C-27	10° 14' 24"	750.00'	67.20'	134.04'	N37° 57' 19"E	133.86'
C-28	6° 27' 04"	750.00'	42.27'	84.45'	N39° 50' 59"E	84.40'
C-29	14° 53' 18"	500.00'	65.33'	129.92'	N44° 04' 05"E	129.56'
C-30	0° 26' 20"	2040.00'	7.81'	15.63'	S39° 46' 14"E	15.63'
C-31	18° 18' 05"	575.00'	92.62'	183.67'	N47° 39' 23"E	182.89'
C-32	5° 40' 13"	890.00'	44.08'	88.08'	S35° 40' 14"W	88.04'
C-33	5° 29' 09"	610.00'	29.22'	58.40'	S35° 34' 42"W	58.38'
C-34	21° 22' 13"	1310.93'	247.35'	488.95'	N43° 39' 47"W	486.12'

FINAL PLAT

Southpointe Phase 7

58.801 Acres out of the Seth M. Blair Survey Abstract No. 72

and Cresanto Vela Survey Abstract No. 851

City of Mansfield, Johnson County, Texas

180 Residential Lots

6 Open Space Lots

1/14/2022

PREPARED BY

Graham Associates, Inc.
CONSULTING ENGINEERS & PLANNERS
600 SIX FLAGS DRIVE, SUITE 600
ARLINGTON, TEXAS 76011 (817) 460-4030
TYPE PRINT: 1-10/10/15/16/17/18/19/2