

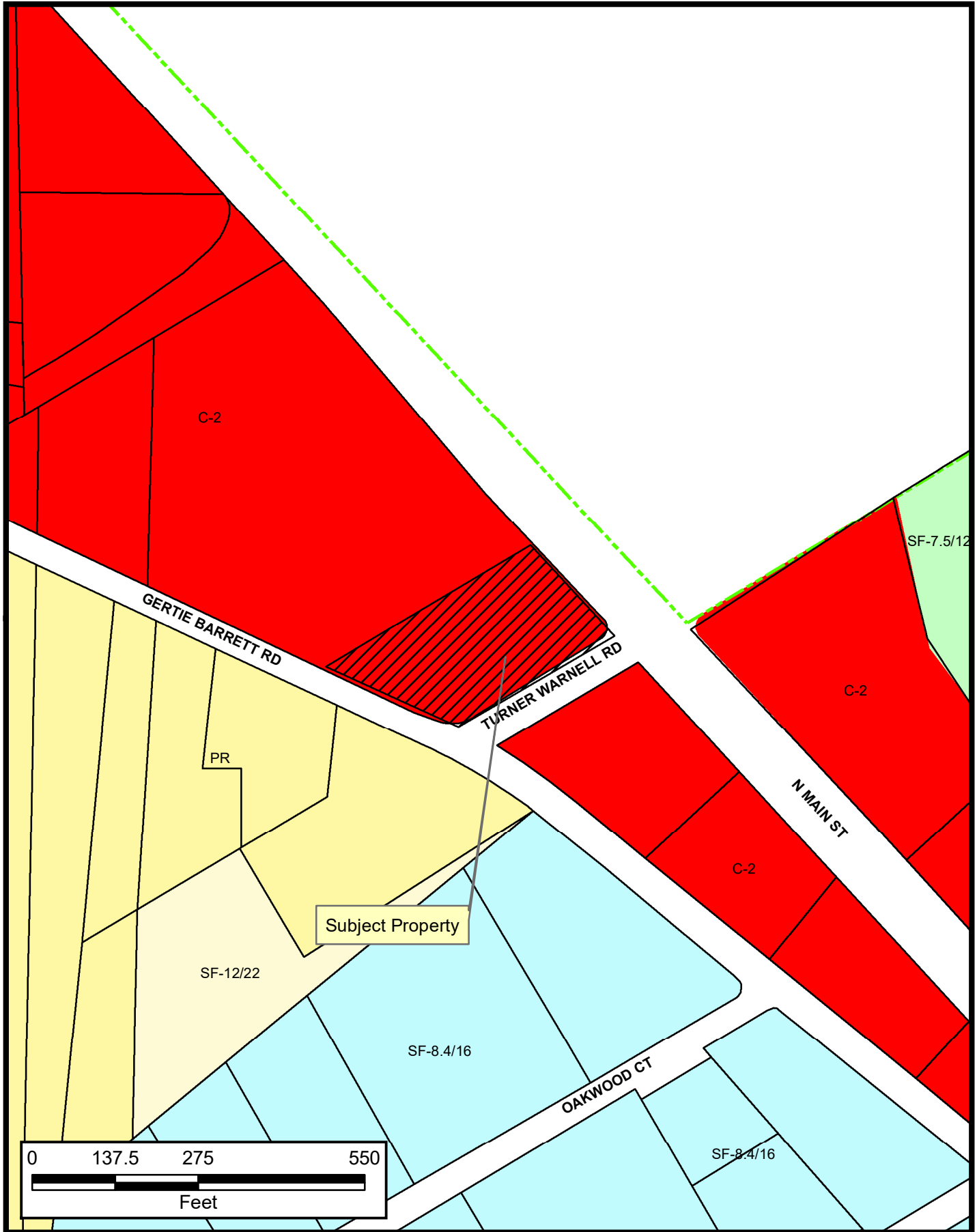

SUP#20-006

This information is for illustrative purposes only. Not for design or development purposes. Site-specific studies may be required to obtain accurate feature locations. Every effort is made to ensure the information displayed here is accurate; however, the City of Mansfield makes no claims to its accuracy or completeness.

8/25/2021



Property Owner Notification for SUP#20-006

LEGAL DESC 1	LEGAL DESC 2	OWNER NAME	OWNER ADDRESS	CITY	ZIP
MABRA ACRES ADDITION	LOT 1	MILAN, OMAR M & MICHELLE DAWN	160 OAKWOOD CT	MANSFIELD, TX	76063
MEP & PRR CO SURVEY	A 1828	CHOWDURY, AKRAM H	3100 HAZELWOOD CT	BEDFORD, TX	76021
MEP & PRR CO SURVEY	A 1828	PREUSSER, WILLIAM & CAROL	3029 GERTIE BARRETT RD	MANSFIELD, TX	76063-8599
MEP & PRR CO SURVEY	A 1828	BISBEE BAPTIST CHURCH OF MANSFIELD	3001 GERTIE BARRETT RD	MANSFIELD, TX	76063-8599
MEP & PRR CO SURVEY	A 1828	BISBEE BAPTIST CHRUCH OF MANSFIELD	3001 GERTIE BARRETT RD	MANSFIELD, TX	76063-8599
MEP & PRR CO SURVEY	A 1828	CHOWDURY, AKRAM H	3100 HAZELWOOD CT	BEDFORD, TX	76021
MEP & PRR CO SURVEY	A 1828	BISBEE BAPTIST CHURCH OF MANSFIELD	3001 GERTIE BARRETT RD	MANSFIELD, TX	76063-8599
R & C BUSINESS CENTER ADDN	BLK 1	SUMMERS, CRAIG	171 BUSHNELL RD	BOZEMAN, MT	59718
ROLLING ACRES ADDITION-MANSFLD	BLK	B & B FAMILY LP	2925 E DIVISION ST	ARLINGTON, TX	76011-6710