



Subject Property



ZC#24-008

This information is for illustrative purposes only. Not for design or development purposes. Site-specific studies may be required to obtain accurate feature locations. Every effort is made to ensure the information displayed here is accurate; however, the City of Mansfield makes no claims to its accuracy or completeness.

6/4/2024

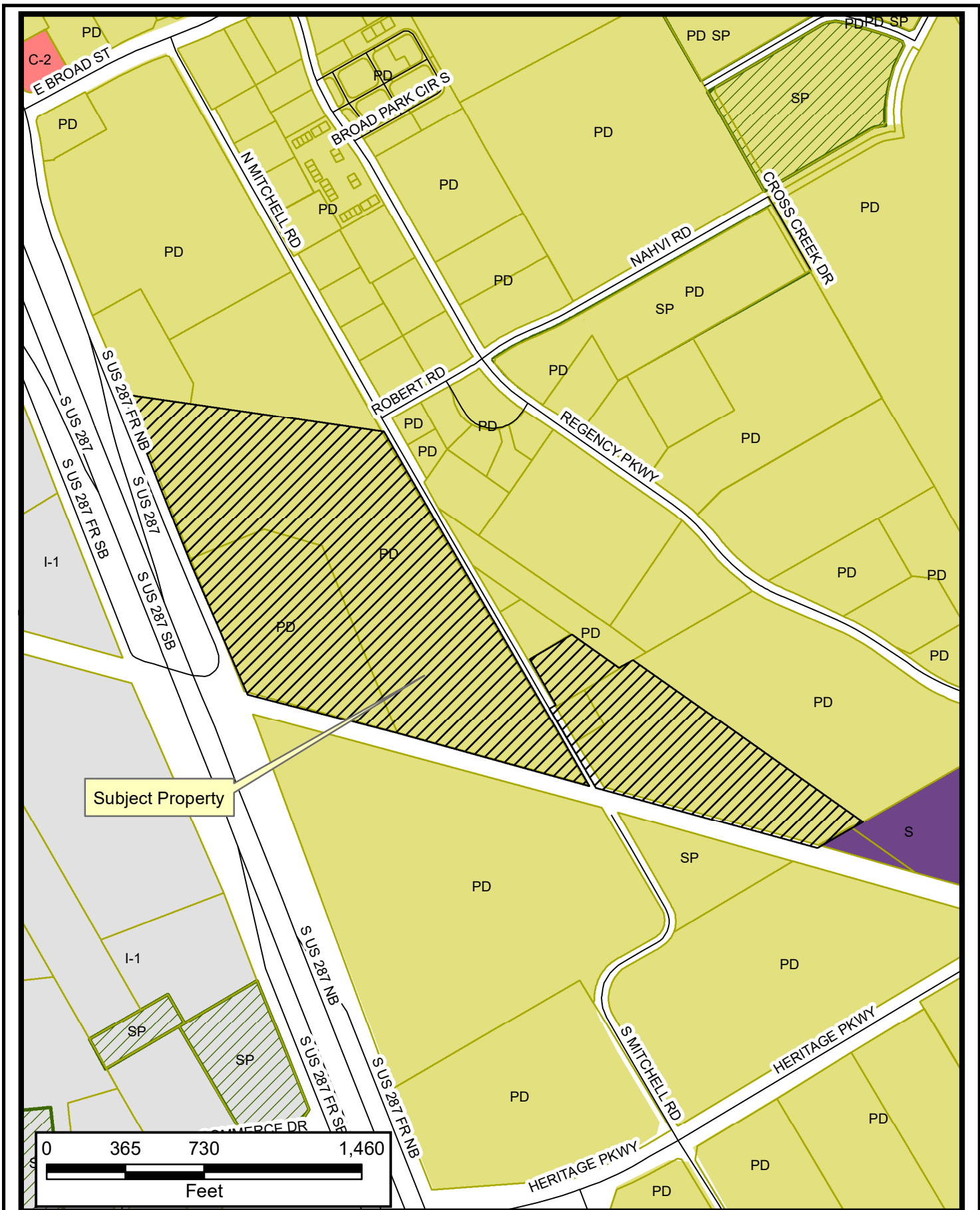

Subject Property

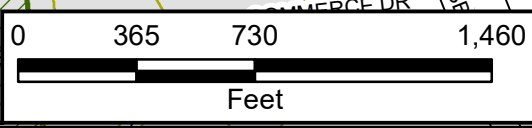

ZC#24-008

This information is for illustrative purposes only. Not for design or development purposes. Site-specific studies may be required to obtain accurate feature locations. Every effort is made to ensure the information displayed here is accurate; however, the City of Mansfield makes no claims to its accuracy or completeness.

6/4/2024

Property Owner Notification for ZC#24-008

LEGAL DESC 1	LEGAL DESC 2	OWNER NAME	OWNER ADDRESS	CITY	ZIP
FOUNTAINVIEW CENTER	BLK 1	ARGAR PRO INVESTMENTS LLC	8760 CR 612	MANSFIELD, TX	76063
FOUNTAINVIEW CENTER	BLK 1	OAKS ON THE RIDGE LLC	134 E CHURCH ST	GRAND PRAIRIE, TX	75050
GALLOWAY ADDITION	LOT 4	BV MITCHELL LLC	9311 LANSHIRE DR	DALLAS, TX	75238
GREGG, MILTON SURVEY	A 555	MANSFIELD ECONOMIC DEVELOPMENT	301 S MAIN ST	MANSFIELD, TX	76063-3106
GREGG, MILTON SURVEY	A 555	CITY OF MANSFIELD	1200 E BROAD ST	MANSFIELD, TX	76063-1805
HALL, J ADDITION	LOT 1	HAWIDI, DINA	2844 MARIPOSA DR	GRAND PRAIRIE, TX	75054
HALL, J ADDITION	LOT 1	HAWIDI, DINA	2844 MARIPOSA DR	GRAND PRAIRIE, TX	75054
HALL, J ADDITION	LOT 2	CITY OF MANSFIELD	1200 E BROAD ST	MANSFIELD, TX	76063-1805
HERITAGE BUSINESS PARK-MANSFLD	BLK 1	RMS HOLDINGS V LLC	1275 QUARRY ST	CORONA, CA	92879
MANSFIELD RETAIL CENTER ADDITION	BLK 1	HEB GROCERY CO LP	3890 W NORTHWEST HWY STE 300	DALLAS, TX	75220
MC ANEAR INDUSTRIAL PARK ADDN	BLK 1	MCCASLIN CONSULTING INC	100 N MITCHELL RD	MANSFIELD, TX	76063-5407
MCANEAR, ELIZABETH SURVEY	A 1005	TOTAL E&P USA REAL ESTATE LLC	PO BOX 17180	FORT WORTH, TX	76102
MCANEAR, ELIZABETH SURVEY	A 1005	WATER BOARD	PO BOX 4508	FORT WORTH, TX	76164-0508
MCANEAR, ELIZABETH SURVEY	A 1005	CITY OF MANSFIELD	1200 E BROAD ST	MANSFIELD, TX	76063-1805
MCANEAR, ELIZABETH SURVEY	A 1005	CITY OF MANSFIELD	1200 E BROAD ST	MANSFIELD, TX	76063-1805
MCANEAR, ELIZABETH SURVEY	A 1005	CRP/AI MANSFIELD OWNER LP	820 GESSNER RD STE 1000	HOUSTON, TX	77024
MCCASLIN BUSINESS PARK	BLK 1	VITX LLC	1700 ROBERT RD SUITE 100	MANSFIELD, TX	76063-9127
MCCASLIN BUSINESS PARK	BLK 2	MASTER METER INC	101 REGENCY PKWY	MANSFIELD, TX	76063-5093
MCCASLIN BUSINESS PARK	BLK 2	TALLY, JIM	2101 BAY COVE CT	ARLINGTON, TX	76013-5247

Property Owner Notification for ZC#24-008

LEGAL DESC 1	LEGAL DESC 2	OWNER NAME	OWNER ADDRESS	CITY	ZIP
ROBERTSON ADDITION	LOT 1	D & S PLASTICS INTL	PO BOX 3646	HOUSTON, TX	77253
ROBERTSON, JOHN SURVEY	A 1317	BROAD STREET US 287 LTD	2000 MCKINNEY AVE STE 1000	DALLAS, TX	75201
ROBERTSON, JOHN SURVEY	A 1317	BV MITCHELL LLC	9311 LANSHIRE DR	DALLAS, TX	75238
ROBERTSON, JOHN SURVEY	A 1317	BV MITCHELL LLC	9311 LANSHIRE DR	DALLAS, TX	75238