

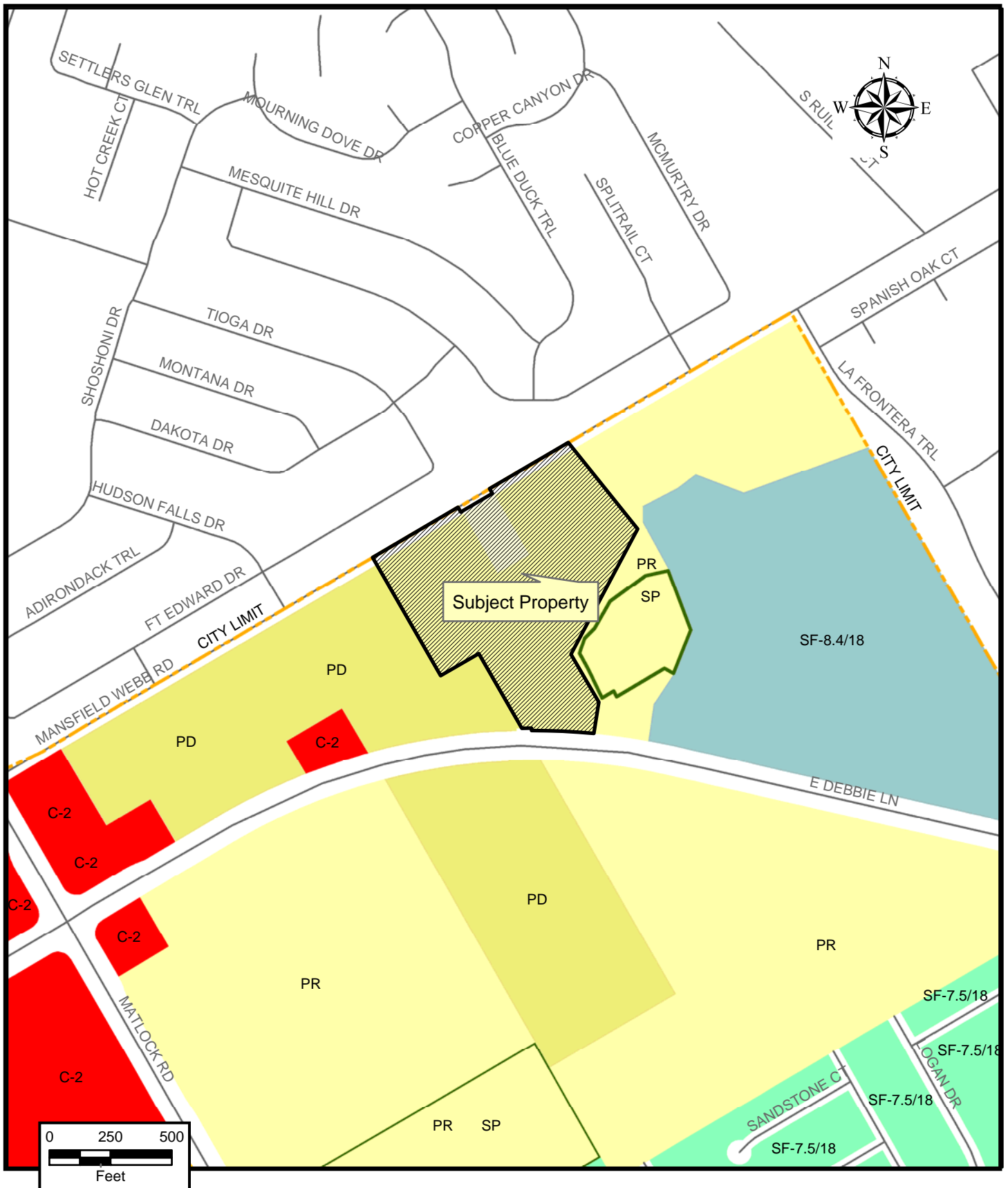

This information is for illustrative purposes only. Not for design or development purposes. Site-specific studies may be required to obtain accurate feature locations. Every effort is made to ensure the information displayed here is accurate; however, the City of Mansfield makes no claims to its accuracy or completeness.

ZC# 13-006

07/16/2013



This information is for illustrative purposes only. Not for design or development purposes. Site-specific studies may be required to obtain accurate feature locations. Every effort is made to ensure the information displayed here is accurate; however, the City of Mansfield makes no claims to its accuracy or completeness.

ZC# 13-006

06/21/2013

Property Owner Notification for ZC# 13-006

LEGAL DESC 1	LEGAL DESC 2	OWNER NAME	OWNER ADDRESS	CITY	ZIP
			*** NO ADDRESS ***	*** NO CITY ***	* NO ZIP *
COMMUNITY OF HOPE	BLK 1 LOT 1	COMMUNITY OF HOPE UMC INC	PO BOX 2078	MANSFIELD, TX	76063-0019
COMMUNITY OF HOPE	BLK 1 LOT 1	COMMUNITY OF HOPE UMC INC	PO BOX 2078	MANSFIELD, TX	76063-0019
COMMUNITY OF HOPE	BLK 1 LOT 1	COMMUNITY OF HOPE UMC INC	PO BOX 2078	MANSFIELD, TX	76063-0019
ERVIN ADDITION	BLK 1 LOT 1	ERVIN, BILLY W ETUX SANDRA KAY	1700 MANSFIELD WEBB RD	MANSFIELD, TX	76063-5012
GRIMSLEY, JAMES SURVEY	A 578 TR 2	ERVIN, ROBERT ETAL	1600 E DEBBIE LN	MANSFIELD, TX	76063
GRIMSLEY, JAMES SURVEY	A 578 TR 2B	ERVIN, ELMER JR EST	1600 E DEBBIE LN	MANSFIELD, TX	76063
GRIMSLEY, JAMES SURVEY	A 578 TR 2D01	MANSFIELD ERVIN MINERALS LTD	1600 E DEBBIE LN	MANSFIELD, TX	76063
GRIMSLEY, JAMES SURVEY	A 578 TR 2B03	ERVIN, ELMER JR EST	1600 E DEBBIE LN	MANSFIELD, TX	76063