

EXHIBIT A

**LEGAL DESCRIPTION
MAIN STREET VILLAGE
14.468 ACRES**

BEING a 14.468 acre tract of land situated in the Thomas J. Hanks Survey, Abstract No. 644, Tarrant County, Texas, being all of that tract of land described as "Tract 1" in Cash Warranty Deed conveyed to Prairie Vista Corporation under Instrument No. D209157152, Deed Records, Tarrant County, Texas (D.R.T.C.T.), and being more particularly described by metes and bounds as follows:

BEGINNING at the most southern corner of Lot 1, Block 3 of Berryhill Phase 1, an addition to the City of Mansfield according to the plat thereof recorded under Instrument No. D197128761, Plat Records, Tarrant County, Texas (P.R.T.C.T.), said point being in the northerly line of Sherman Drive (a 50 foot right-of-way);

THENCE South 59 degrees 47 minutes 26 seconds West, along the common line between said Prairie Vista tract and said Sherman Drive, a distance of 19.41 feet to the beginning of a circular curve to the left;

THENCE Southwesterly, along said circular curve to the left, having a radius of 358.08 feet, an arc length of 158.61 feet, a central angle of 25 degrees 22 minutes 46 seconds, and a chord which bears South 47 degrees 06 minutes 02 seconds West, a distance of 157.32 feet to the end of curve;

THENCE South 34 degrees 24 minutes 39 seconds West, along the common line between said Prairie Vista tract and said Sherman Drive, a distance of 79.09 feet to a point found for the most southern corner of said Prairie Vista tract, said point being in the northeast line of South Main Street, said point being the intersection between the northwest line of said Sherman Drive and the northeast line of said South Main Street;

THENCE North 55 degrees 34 minutes 29 seconds West, along the common line between said Prairie Vista tract and said South Main Street, a distance of 1613.12 feet to the beginning of a circular curve to the right;

THENCE Northwesterly, along said circular curve to the right having a radius of 1860.08 feet, an arc length of 137.98 feet, a central angle of 04 degrees 15 minutes 01 seconds, and a chord which bears North 53 degrees 26 minutes 29 seconds West, a distance of 137.95 feet to the end of curve;

THENCE North 63 degrees 20 minutes 57 seconds East, departing the common line between said Prairie Vista tract and said South Main Street, a distance of 150.97 feet to a point for a corner;

THENCE North 43 degrees 33 minutes 30 seconds West, a distance of 479.22 feet to a point for a corner, said corner being in the south line of Lot 2 of Troy Sells Addition, an addition to the City of Mansfield according to the plat thereof recorded under Instrument No. D193191420 (P.R.T.C.T.);

THENCE North 60 degrees 12 minutes 56 seconds East, along the common line between said Prairie Vista tract and said Lot 2, a distance of 450.53 feet to a point for a corner, said corner being in the north line of Berryhill Phase 2, an addition to the City of Mansfield according to the plat thereof recorded under Instrument No. D199038904 (P.R.T.C.T.);

**LEGAL DESCRIPTION
MAIN STREET VILLAGE
14.468 ACRES**

THENCE departing the south line of said Lot 2, along the common line between said Prairie Vista tract and the southwest line of said Berryhill Phase 2 for the following five (5) calls:

- South 11 degrees 33 minutes 02 seconds East, a distance of 88.90 feet to a point for a corner;
- South 47 degrees 14 minutes 04 seconds East, a distance of 162.43 feet to a point for a corner;
- South 30 degrees 11 minutes 15 seconds East, a distance of 200.00 feet to a point for a corner;
- South 01 degrees 04 minutes 23 seconds West, a distance of 263.19 feet to a point for a corner;
- South 55 degrees 01 minutes 13 seconds East, a distance of 192.85 feet to the most southern corner of Lot 51, Block 3 of said Berryhill Phase 2, said corner being the most western corner of Lot 50, Block 3 of said Berryhill phase 1;

THENCE along the common line between said Prairie Vista tract and said Berryhill Phase 1 for the following four (4) calls:

- South 55 degrees 32 minutes 53 seconds East, a distance of 106.25 feet to a point for a corner;
- South 45 degrees 01 minutes 00 seconds East, a distance of 106.87 feet to a point for a corner;
- South 69 degrees 59 minutes 17 seconds East, a distance of 78.85 feet to a point for a corner;
- South 55 degrees 35 minutes 21 seconds East, a distance of 962.94 feet to the POINT OF BEGINNING, containing 630,211 square feet or 14.468 acres of land, more or less.



[Handwritten signature]
05/08/17

**LEGAL DESCRIPTION
MAIN STREET VILLAGE
1.662 ACRES**

Being 1.662 acres of land located in the Thomas J. Hanks Survey, Abstract No. 644, Tarrant County, Texas, being tract 2 of that tract of land described in the deed to Prairie Vista Corporation, as recorded in Document No. D209157152, Deed Records, Tarrant County, Texas, said 1.662 acres of land being more particularly described as follows:

BEGINNING at a point for corner in the Easterly line South Main Street at the intersection of the Southerly right-of-way line of Sherman Drive according to the plat of Berryhill, Phase One an addition to the City of Mansfield, Tarrant County, Texas, recorded in Cabinet A, Slide 3648, Plat Records, Tarrant County, Texas;

THENCE along said Southerly right-of-way line as follows:

1. N34°24'39"E, a distance of 79.10 feet to a point for corner;
2. Northeasterly, 136.46 feet along a non tangent curve to the right, having a radius of 308.08 feet, a central angle of 25°22'44" and a chord bearing N47°06'02"E, 135.35 feet to a point for corner;
3. N59°47'26"E, a distance of 38.92 feet to a point for corner at the East corner of Lot 18, Block 18, according to said plat of Berryhill Phase One;

THENCE S30°12'34"E, a distance of 533.33 feet along the Westerly line of said Block 8 to a point for corner at the South corner of Lot 11, in said Block 8, Berryhill, Phase One;

THENCE S59°34'03"W, a distance of 19.72 feet to a point in said the Easterly line of said South Main Street;

THENCE N55°34'29"W, a distance of 519.89 feet along said South Main Street to the POINT OF BEGINNING, containing 1.662 acres of land.

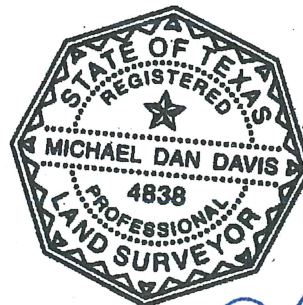

[Handwritten signature]
05/08/17